

Intensive Japanese Programs

履修案内

Spring and Summer Terms

2024

令和6年度春～夏学期



Center for Japanese Language and Culture
Osaka University

大阪大学日本語日本文化教育センター

INTENSIVE JAPANESE PROGRAMS

Spring and Summer Terms

2024

Contents

Academic Calendar	v
Academic Calendar Spring and Summer Terms, 2024	v
Intensive Japanese Programs, CJLC	2
1. Types of Programs	2
2. Classes	2
3. Examinations and Academic Record	4
4. Approval of Completion	6
5. Subject Registration	8
6. Operation of the CJLC Office	10
7. CJLC Library Room	12
8. Forms of Certificates	14
9. Cancellation of Classes due to weather warnings, disasters, and suspension of public transportation	16
Undergraduate Students Program [U]	20
1. Program Outline	20
2. Requirements for [U] Program Certificate	20
3. Outline of Subjects	22
3-1. Japanese Language Subjects	24
3-2. Required Subjects Other than Japanese Subjects	26
4. Entrance into University	28
Japanese Studies Program [J]	30
1. Program Outline	30
2. Requirements for [J] Program Certificate	34
3. Outline of Subjects	36
3-1. Required Subjects	36
3-2. Electives	36
4. Extracurricular Activities	48
Maple Program [M]	50
1. Program Outline	50
2. Requirements for [M] Program Certificate	54
3. Outline of Subjects	56
3-1. Required Subjects	56
3-2. Electives	58
4. Extracurricular Activities	70

OU Foundation Program [F]	72
1. Program Outline	72
2. Requirements for [F] Program Certificate	74
3. Outline of Subjects	78
3-1. Japanese Language Subjects	78
3-2. Subjects Other Than Japanese Language	86
List of Classes	90
Weekly Schedule	98
Abbreviations	107
Minoh Campus Map	108
Floor Map	110
Advisors	114

ねんど がくねんれき 2024年度 学年暦 Academic Calendar 2024
 ≪Uプログラム (U Program) ≫

年月	日	曜日	祝日	行事
2024年 4月	1	Mon		
	2	Tue		
	3	Wed		
	4	Thu		
	5	Fri		
	6	Sat		
	7	Sun		オリエンテーション
	8	Mon		
	9	Tue		
	10	Wed		
	11	Thu		
	12	Fri		
5月	13	Sat		
	14	Sun		健康診断
	15	Mon		
	16	Tue		
	17	Wed		
	18	Thu		
6月	19	Fri		
	20	Sat		
	21	Sun		
	22	Mon		
	23	Tue		
	24	Wed		
7月	25	Thu		
	26	Fri		
	27	Sat		
	28	Sun		
	29	Mon		
	30	Tue		
8月	31	Wed		
	1	Thu		
	2	Fri		
	3	Sat		
	4	Sun		
	5	Mon		
9月	6	Tue		
	7	Wed		
	8	Thu		
	9	Fri		
	10	Sat		
	11	Sun		
10月	12	Mon		
	13	Tue		
	14	Wed		
	15	Thu		
	16	Fri		
	17	Sat		
11月	18	Sun		
	19	Mon		
	20	Tue		
	21	Wed		
	22	Thu		
	23	Fri		
12月	24	Sat		
	25	Sun		
	26	Mon		
	27	Tue		
	28	Wed		
	29	Thu		
2025年 1月	30	Fri		
	31	Sat		
	1	Sun		
	2	Mon		
	3	Tue		
	4	Wed		
2月	5	Thu		
	6	Fri		
	7	Sat		
	8	Sun		
	9	Mon		
	10	Tue		
3月	11	Wed		
	12	Thu		
	13	Fri		
	14	Sat		
	15	Sun		
	16	Mon		
4月	17	Tue		
	18	Wed		
	19	Thu		
	20	Fri		
	21	Sat		
	22	Sun		
5月	23	Mon		
	24	Tue		
	25	Wed		
	26	Thu		
	27	Fri		
	28	Sat		
6月	29	Sun		
	30	Mon		
	1	Tue		
	2	Wed		
	3	Thu		
	4	Fri		
7月	5	Sat		
	6	Sun		
	7	Mon		
	8	Tue		
	9	Wed		
	10	Thu		
8月	11	Fri		
	12	Sat		
	13	Sun		
	14	Mon		
	15	Tue		
	16	Wed		
9月	17	Thu		
	18	Fri		
	19	Sat		
	20	Sun		
	21	Mon		
	22	Tue		
10月	23	Wed		
	24	Thu		
	25	Fri		
	26	Sat		
	27	Sun		
	28	Mon		
11月	29	Tue		
	30	Wed		
	1	Thu		
	2	Fri		
	3	Sat		
	4	Sun		
12月	5	Mon		
	6	Tue		
	7	Wed		
	8	Thu		
	9	Fri		
	10	Sat		
2025年 1月	11	Sun		
	12	Mon		
	13	Tue		
	14	Wed		
	15	Thu		
	16	Fri		
2月	17	Sat		
	18	Sun		
	19	Mon		
	20	Tue		
	21	Wed		
	22	Thu		
3月	23	Fri		
	24	Sat		
	25	Sun		
	26	Mon		
	27	Tue		
	28	Wed		
4月	29	Thu		
	30	Fri		
	1	Sat		
	2	Sun		
	3	Mon		
	4	Tue		

年月	日	曜日	祝日	行事
2024年 10月	1	Mon		
	2	Tue		
	3	Wed		
	4	Thu		
	5	Fri		
	6	Sat		
	7	Sun		
	8	Mon		
	9	Tue		
	10	Wed		
	11	Thu		
	12	Fri		
11月	13	Sat		
	14	Sun		
	15	Mon		
	16	Tue		
	17	Wed		
	18	Thu		
12月	19	Fri		
	20	Sat		
	21	Sun		
	22	Mon		
	23	Tue		
	24	Wed		
2025年 1月	25	Thu		
	26	Fri		
	27	Sat		
	28	Sun		
	29	Mon		
	30	Tue		
2月	31	Wed		
	1	Thu		
	2	Fri		
	3	Sat		
	4	Sun		
	5	Mon		
3月	6	Tue		
	7	Wed		
	8	Thu		
	9	Fri		
	10	Sat		
	11	Sun		
4月	12	Mon		
	13	Tue		
	14	Wed		
	15	Thu		
	16	Fri		
	17	Sat		
5月	18	Sun		
	19	Mon		
	20	Tue		
	21	Wed		
	22	Thu		
	23	Fri		
6月	24	Sat		
	25	Sun		
	26	Mon		
	27	Tue		
	28	Wed		
	29	Thu		
7月	30	Fri		
	31	Sat		
	1	Sun		
	2	Mon		
	3	Tue		
	4	Wed		
8月	5	Thu		
	6	Fri		
	7	Sat		
	8	Sun		
	9	Mon		
	10	Tue		
9月	11	Wed		
	12	Thu		
	13	Fri		
	14	Sat		
	15	Sun		
	16	Mon		
10月	17	Tue		
	18	Wed		
	19	Thu		
	20	Fri		
	21	Sat		
	22	Sun		
11月	23	Mon		
	24	Tue		
	25	Wed		
	26	Thu		
	27	Fri		
	28	Sat		
12月	29	Sun		
	30	Mon		
	31	Tue		
	1	Wed		
	2	Thu		
	3	Fri		
2025年 1月	4	Sat		
	5	Sun		
	6	Mon		
	7	Tue		
	8	Wed		
	9	Thu		
2月	10	Fri		
	11	Sat		
	12	Sun		
	13	Mon		
	14	Tue		
	15	Wed		
3月	16	Thu		
	17	Fri		
	18	Sat		
	19	Sun		
	20	Mon		
	21	Tue		
4月	22	Wed		
	23	Thu		
	24	Fri		
	25	Sat		
	26	Sun		
	27	Mon		
5月	28	Tue		
	29	Wed		
	30	Thu		
	31	Fri		
	1	Sat		
	2	Sun		
6月	3	Mon		
	4	Tue		
	5	Wed		
	6	Thu		
	7	Fri		
	8	Sat		
7月	9	Sun		
	10	Mon		
	11	Tue		
	12	Wed		
	13	Thu		
	14	Fri		
8月	15	Sat		
	16	Sun		
	17	Mon		
	18	Tue		
	19	Wed		
	20	Thu		
9月	21	Fri		
	22	Sat		
	23	Sun		
	24	Mon		
	25	Tue		
	26	Wed		
10月	27	Thu		
	28	Fri		
	29	Sat		
	30	Sun		
	31	Mon		
	1	Tue		
11月	2	Wed		
	3	Thu		
	4	Fri		
	5	Sat		
	6	Sun		
	7	Mon		
12月	8	Tue		
	9	Wed		
	10	Thu		
	11	Fri		
	12	Sat		
	13	Sun		
2025年 1月	14	Mon		
	15	Tue		
	16	Wed		
	17	Thu		
	18	Fri		
	19	Sat		
2月	20	Sun		
	21	Mon		
	22	Tue		
	23	Wed		
	24	Thu		
	25	Fri		
3月	26	Sat		
	27	Sun		
	28	Mon		
	29	Tue		
	30	Wed		
	31	Thu		

年月	日	曜日	祝日	行事
2024年 4月	5	Mon		
	6	Tue		
	7	Wed		
	8	Thu		
	9	Fri		
	10	Sat		
	11	Sun		
	12	Mon		
	13	Tue		
	14	Wed		
	15	Thu		
	16	Fri		
5月	17	Sat		
	18	Sun		
	19	Mon		

ねんど がくねんれき
2024 年度 学年暦

Academic Calendar 2024

《 J/M プログラム (J/M Program) 》

よび 曜日(Day) つき 月(Month)	にち 日 Sun.	げつ 月 Mon.	か 火 Tue.	すい 水 Wed.	もく 木 Thu.	きん 金 Fri.	ど 土 Sat.
2024 年 4月 April		1	2	3	4	5	6
	7	①	①	①	①	①	13
	14	②	②	②	②	②	20
	21	③	③	③	③	③	27
	28	昭和の日	月曜④				
5月 May				大学祭準備	大学祭	憲法記念日	みどりの日
	5	こどもの日	振替休日	④	④	④	④
	12	⑤	⑤	⑤	⑤	⑤	18
	19	⑥	⑥	⑥	⑥	⑥	25
	26	⑦	⑦	⑦	⑦	⑦	
	6月 June						
2		⑧	⑧	⑧	⑧	⑧	8
9		⑨	⑨	⑨	⑨	⑨	15
16		⑩	⑩	見学旅行(休講)	⑩	⑩	22
23		⑪	⑪	⑪	⑪	⑪	29
30							
7月 July			⑫	⑫	⑪	⑪	⑫
	7	⑬	⑬	⑫	⑫	⑬	13
	14	海の日	補講	⑬	⑬	⑭	20
	21	⑭	⑭	⑭	⑭	⑮	27
	28	⑮	⑮	⑮			
8月 August					⑮	補講	3
	4	特別授業				修了式	10
	11	山の日	振替休日				17
	18						24
	25						31
9月 September	1	2	3	4	5	6	7
	8	9	10	11	12	13	14
	15	敬老の日					21
	22	秋分の日	振替休日				28
	29	30					

はる なつがつき
春～夏学期 Spring and Summer Terms

4月8日～19日 April 8 - 19	りしゅうとうろくかくにんきかん 履修登録確認期間 Class Registration Confirmation Period
4月30日 April 30	げつよびが じゅぎょう 月曜日の授業 Monday Classes
5月1日～2日 May 1 - 2	だいがくさいじゆんび だいがく 大学祭準備、大学祭 University Festival Preparation, Festival
6月19日～20日 June 19 - 20	けんがかりょうきょうこう 見学旅行(休講) Study Trip (No Classes)
7月16日、8月2日 July 16, August 2	ほこう 補講 Make-up Classes
7月19日～8月1日 July 19 - August 1	がっきまつしけん 学期末試験 Final Examination
8月5日 August 5	とくべつじゅぎょう 特別授業 Special Classes
8月9日 August 9	しゅうりょうしき 修了式 Closing Ceremony
8月10日～ August 10 -	なつやすみ 夏休み Summer Holidays

しゅくじつ
《 祝日 Public Holidays 》

4月29日 April 29	しやうわ のひ 昭和の日 Shōwa Day
5月3日、4日、5日、6日 May 3, 4, 5, 6	けんぽう きねんび みどりのひ こどものひ 憲法記念日、みどりの日、こどもの日 振替休日 Constitution Memorial Day, Greenery Day, Children's Day Substitute Holiday
7月15日 July 15	うみ のひ 海の日 Marine Day
8月11日、12日 August 11, 12	やま のひ ふりかえきゆうじつ 山の日、振替休日 Mountain Day, Substitute Holiday
9月16日 September 16	けいろう のひ 敬老の日 Respect for the Aged Day
9月22日、23日 September 22, 23	しゅうぶん ひ ふりかえきゆうじつ 秋分の日、振替休日 Autumnal Equinox Day, Substitute Holiday

じゅぎょうび
授業日 Classes

ほこうび
補講日 Make-up Classes

しけんび
試験日 Examinations

Intensive Japanese Programs

1. Types of Programs

The Center for Japanese Language and Culture, Osaka University, offers various short-term intensive Japanese programs, mainly for Monbu-kagaku-sho (MEXT) scholarship students. They are categorized into the following programs according to the content. Each program is described in detail in its proper section.

- ① Undergraduate Students Program [U] (enrolled in April, one-year program)
- ② Japanese Studies Program [J] (enrolled in October, one-year program)
- ③ Maple Program [M] (enrolled in October, one-year program)
- ④ OU Foundation Program [F] (enrolled in October, half-year program)
- ⑤ OU-MU Short-term Program in Japanese Language and Culture [O] (enrolled in March, half-year program)

2. Classes

(1) Terms

There are four terms (two semesters) each year: Spring and Summer Terms (Spring Semester) (April 1 to September 30) and Fall and Winter Terms (Fall Semester) (October 1 to March 31 of the following year). Classes in J and M programs are given for 30 weeks a year : 15 weeks each in spring and fall semesters, and in U program, for 35 weeks a year. Also, classes in F program are given for 15 weeks only in fall semester.

(2) Class meeting times

There are five 90-minute time periods, each day from Monday to Friday.

Period	Class meeting times
1st Period	8 : 50 a.m. – 10 : 20 a.m.
2nd Period	10 : 30 a.m. – 12 : 00 p.m.
3rd Period	1 : 30 p.m. – 3 : 00 p.m.
4th Period	3 : 10 p.m. – 4 : 40 p.m.
5th Period	4 : 50 p.m. – 6 : 20 p.m.

(3) Credit hours

According to the type of course, credit hours are prescribed as follows:

Category	Lecture/Seminar		Category	Recitation	
Credit hours	Class: 15 credit hours	Private study: 30 credit hours	Credit hours	Class: 30 credit hours	Private study: 15 credit hours

(4) Cancellation of classes

Cancellation of a class will be announced on the bulletin board near the office of the CJLC Office. Be sure to check the bulletin board before attending a class.

When the instructor in charge does not appear in the classroom within 30 minutes from the start time of the class and there is no cancellation notice on the bulletin board, please contact the CJLC Office and follow its instructions.

Classes may be cancelled when public transportation service is suspended or a storm warning as well as an emergency warning are issued. Please refer to the Guidelines for Cancellation of Classes due to weather warnings, disasters, and suspension of public transportation (see p.16) to see whether classes will be cancelled.

(5) Supplementary classes

Supplementary classes may be held to make up for a delay in progress or a cancelled class. Information on supplementary classes will be given directly by the instructor in charge and posted on the bulletin board.

3. Examinations and Academic Record

(1) Examinations

Evaluation methods include written and oral examinations, reports, papers, practical and other examinations. For some courses, the rate of attendance and marks in unscheduled examinations are also reflected in grading, or substituted for marks in scheduled examinations. For the evaluation method of each course, see the volume Syllabus through KOAN.

● Matters to note regarding examinations

- ① Information on scheduled examinations will be posted on the bulletin board or made an oral announcement from the instructor in charge.
- ② If you appear in the classroom later than 30 minutes from the start time of the examination, you will not be allowed to take the examination. Be careful not to be late for an examination. Students may leave the classroom 45 minutes from the start time of an examination.
- ③ If a student is caught cheating or doing other unfair conduct in an examination, he/she should immediately stop the test, and his/her registration for the subject will be cancelled. Students guilty of unfair conduct will be subjected to disciplinary action in accordance with the school regulations.
- ④ Taking an examination in a subject for which you have not been registered will not receive credit.

(2) Grading

Achievement in each subject is evaluated as Grade S, A, B, C, or F as shown in the table below:

Assessment	Passed				Failed
Grade	S	A	B	C	F
Score (out of 100)	100-90 scores	89-80 scores	79-70 scores	69-60 scores	59-0 scores

(3) Notification of grades

The grades in subjects for which students have registered are notified by Transcript/Academic Record to each student after the closing ceremony.

4. Approval of Completion

(1) Requirements for a certificate

It is necessary to complete all the subjects required in the program. For details, such as the titles of subjects and the numbers of required subjects and electives, see the each program outline given later.

The approval/disapproval of completion of courses is announced in September for the August and summer terms and in March for the fall and winter terms.

(2) Certificate of Completion

Certificates will be issued to students who satisfy all the requirements for completion of the program in the prescribed manner.

5. Subject Registration

(1) Placement: Evaluation of degree of proficiency in Japanese

To register for the subjects offered by the CJLC, students need to be evaluated for their degree of proficiency in Japanese. The evaluation is done through a placement test. You can take grammar, Kanji and composition test at the CJLC website. For more information of the placement test will be notified by Email.

(2) Orientation Sessions by Program

Before or at the beginning of each term, the orientation sessions by program will be held. All the students are required to attend the orientation to take classes in each program. The schedule and location of Orientation Sessions by program will be announced by Email.

(3) Registration

Subject registration questionnaire will be conducted every term.

If you fail to register for a subject, you will not be graded for the subject or considered to have completed the subject, even if you attend the class. Any corrections in the subject registration forms should be made within the registration period. Take care in preparing and submitting your registration form.

The last day of the registration period is usually about two weeks after the beginning of classes.

● Matters to note regarding subject registration

- ① You cannot register for a course which is not a designated subject.
- ② For some subjects, students are allowed to register for designated courses only. At the Orientation Sessions by Program mentioned in section (2) above, information will be given about important matters in registration. Be sure to pay attention to this information and follow the instructions in registering for subjects.
- ③ After the deadline of the subject registrations, double-check that all requirements have been completed. If there are any corrections, you must let CJLC office know immediately.

(4) Paper of completion course

In some programs/courses, students are required to submit a paper for completion of the course. In accordance to the instructions in the each program outline given later, submit the paper by the deadline.

6. Operation of the CJLC Office

(1) Office hours

The location and office hours of the CJLC Office are as follows :

※ Monday-Friday (holidays excluded)

Location	7th floor, Center for Japanese Language and Culture Office	
Office hours	a.m.	10:00 - 11:30
	p.m.	12:30 - 4:30

N.B. Unscheduled closures or changes in the office hours will be announced on the bulletin board.

(2) Communication of curriculum-related information

All curriculum-related information, such as on classes and examinations, will be communicated through the bulletin board or Email. Be sure to check the bulletin board and Email near the office of the CJLC Office before attending a class.

(3) Certificates

For student-related certificates, apply to the CJLC Office, using a Request for Certificate form. A certificate will be issued seven days from the date of application, as a rule. Around the end of the semester (March), when many students make applications, it may take 10 days or so.

Regarding the main student-related certificates issued at the CJLC Office, please refer to page 14.

- ① Transcript / Academic Record
- ② Certificate of Program Completion
- ③ Enrollment Certificate

7. CJLC Library Room

The CJLC Library Room can be found on the 7th floor. The "LIBRARY CARD" is necessary in order to enter the room. In addition to general books, you will find various textbooks as well as workbooks on learning Japanese, and there is an area where students can study while listening to CDs that come with these books.

Regarding Japanese literature material, the library room facilitates equipment for viewing audio visual material: genres ranging from entertainment, movies, drama, to anime and so on. In order to find the material that you want to use, search the "Japanese Literature Data and Audio Visual Materials Database" found on the CJLC website. Students can use the computers and printers in the CJLC Library Room.

The CJLC Library Room is open from Monday through Friday, from 10 a.m. to 6:20 p.m. (holidays excluded).

(Note) The CJLC Library Room will be closed temporarily on an as-needed basis.

8. Forms of Certificates

① - 1 For U Program

No. _____

TRANSCRIPT
(Government Sponsored Foreign Student)

Institution	Center for Japanese Language and Culture	Admission :		
Nationality		Completion :		
ID Number	Name	Date Of Birth		
		Sex		

Curriculum Class Evaluation		
Curriculum Class	Grade	Hrs Per Week
Japanese Language	Listening	
	Reading	
	Grammar	
	Kanji	
	Oral Presentation	
	Composition	
Japanese Cultural Background		
English		
Humanities	Political Science and Economics	
	Japanese History	
	Mathematics(Elective)	
Natural Science	Mathematics	
	Chemistry	
	Physics	
	Biology	

Grading Scale
S : 90 ~ 100
A : 80 ~ 89
B : 70 ~ 79
C : 60 ~ 69
F : 0 ~ 59
N/A : Not Applicable

M/D/YYYY _____

OFFICIAL SEAL OF
Center for Japanese Language and Culture
OSAKA UNIVERSITY

Director
Center for Japanese Language and Culture
OSAKA UNIVERSITY

① - 2 For other Programs

Osaka University Transcript

Name: _____ Date of Birth: _____
 Student Number: _____ Date of Enrollment: _____

S U B J E C T	Credits	Year	Grade

Grade: 01/20/00, 2/00/00, 3/79/70, 04/00/00, 5/00/00, 6/00/00

[Subjects under Academic Major (Major Subjects/Advanced Global Literacy Education)] are categorized as Major Subjects.
 [Subjects under Global Literacy (Advanced Global Literacy Education/Major Subjects)] are categorized as Advanced Global Literacy Education. (Qualify to attend for "Program for Leading Graduate Schools")

This is to certify that the above record is true and correct.

President of Osaka University

Official Seal of
Osaka University
Date:

② Certificate of Program Completion

CERTIFICATE

Program : _____
 Period of Attendance : _____
 Status : _____
 Name : _____
 Sex : _____
 Date of Birth : _____
 Country : _____
 Date of Graduation : _____

This is to certify that the above record is true and correct.

OFFICIAL SEAL OF
Center for Japanese Language and Culture
OSAKA UNIVERSITY

Director
Center for Japanese Language and Culture
Osaka University

③ Enrollment Certificate

CERTIFICATE

Name: _____
 Date of Birth: _____
 Date of Enrollment: _____

This is to certify that the above record is true and correct.

President of Osaka University

Official Seal of
Osaka University

9. Cancellation of Classes Due to Special Circumstances (severe weather/earthquake etc)

- As a general rule, online classes (including regular examinations) will still be held under severe weather warnings.
- However, if circumstances make it difficult to hold online classes, departments may decide to cancel classes. You will be notified via KOAN if classes have been cancelled.
- If you live in/commute through an area which has been issued a storm warning/emergency warning or has experienced an earthquake with a seismic intensity (shindo) of 5+ or higher and you will not be able to attend online classes due to evacuation and/or evacuation preparations, your department will make arrangements to prevent any penalties with regards to your studies, so please contact the academic affairs section of your department.

(1) Weather warning -- "Storm Warning" [*boufuu-keihou*]/"Emergency Warning" [*tokubetsu-keihou*]

In the case of a "storm warning" [*boufuu-keihou*] or "emergency warning" [*tokubetsu-keihou*] (*) being issued for Toyonaka, Suita, Ibaraki, and/or Minoh, classes will be canceled.

If a storm warning is issued while classes are in session, all classes coming after the one in which the warning was issued will also be canceled.

*This schedule also applies for any "Emergency Warning" [*tokubetsu-keihou*] (Emergency Warnings are special warnings that generally signify weather that is much more dangerous than a typical "Storm Warning.")

(2) Cancellation of Classes due to Transportation Interruptions

If public transportation systems are stopped or suspended (here in after "Suspended") (include in case of only portion of line is suspended) due to uncontrollable circumstances by disasters the following procedures will be in effect.

① For Toyonaka Campus students:

Hankyu Takarazuka Line (Umeda-Takarazuka), or Osaka Monorail (all lines)

② For Suita Campus students:

Hankyu Senri Line (Umeda/Tenjimbashisuji 6chome-Kitasenri), or Osaka Monorail (all lines)

③ For Minoh Campus students

Osaka Metro Midosuji Line (include Kita-Osaka Kyuko Line) (Umeda/Minoh-Kayano), or Osaka Monorail (all lines)

However, please be aware that the procedures for cancellation of classes do not apply when the suspended caused by accidents or trouble.

(3) Resumption of Classes after Cancellation for Weather Warning or Suspension of Public Transport Services

Classes will proceed based on the following schedule in case of cancellation for weather warning or suspension of Public Transport Services.

If the weather warning has been canceled or suspension of public transportation has been resolved before 6a.m. → All classes will be held as usual.

If the weather warning has been canceled or suspension of public transportation has been resolved before 9a.m. → Afternoon classes will be held.

If the weather warning or suspension of public transportation service is still continuing at 9a.m. → Classes will be canceled all day.

Note 1: Students in the United Graduate School of Child Development will be contacted by email regarding classes.

Note 2: Severe weather warning/suspension of public transportation are broadcast on the radio, TV, and internet.

(4) Cancellation of Classes Due to Earthquake

In the case of an earthquake with seismic intensity of greater than 5 occurred in Toyonaka, Suita, Ibaraki, and/or Minoh, classes will be canceled. Also, if the earthquake occurred after 5:15 p.m., next day's classes will be canceled all day.

And, in the case of an earthquake occurred out the area stated above, or the case of its seismic intensity of lower than 5, all classes will be adjusted as the "2. Cancellation of Class Due to Transportation Interruption".

(5) Evacuation Instruction or Emergency Safety Measures due to Disaster

In the case of an "evacuation instruction" or "emergency safety measures" (herein after "Evacuation Instruction") due to disaster being issued for Toyonaka, Suita, Ibaraki, and/or Minoh, Department and Division located at the area where Evacuation Advisories issued may cancel classes. Please follow instructions from Department and Division.

(6) Others

① If a class is not cancelled but a student cannot attend due to unavoidable circumstances stated below happened in your residential area or while commuting, he or she can ask the Students Affairs Division in charge not to penalize them for being absent from the class.

*In case of a weather warning same as #1 above is issued

*In case of an earthquake same as #4 above is occurred

*In case of public transportation note stated at #2 is suspended

② In the case that issuance of weather alert and evacuation instruction, suspension of public transportation can be predicted well beforehand, or there is necessity of emergently cancel classes, university may announce class cancellation by official web page or KOAN.

Maple Program [M]

1. Program Outline

The Maple Program (Osaka University Intensive Japanese Language and Culture Program for Exchange Students) is a short-term student exchange program of Osaka University hosted by the Center for Japanese Language and Culture (CJLC). This one-year program consists of two terms: a Fall-Winter term from September to March, and a Spring-Summer term from April to August.

The program is designed to help students improve their Japanese language skills as well as enhance their knowledge of Japanese culture and society, moving them further towards their respective academic goals. Moreover, it aims to cultivate the human resources required to deeply understand Japan from various perspectives by giving students the academic tools to compare and contrast Japanese language, culture and society with their own, and then share that knowledge widely.

A faculty advisor is assigned by the CJLC to each student enrolled in the program to provide advice regarding subject registration and other academic activities.

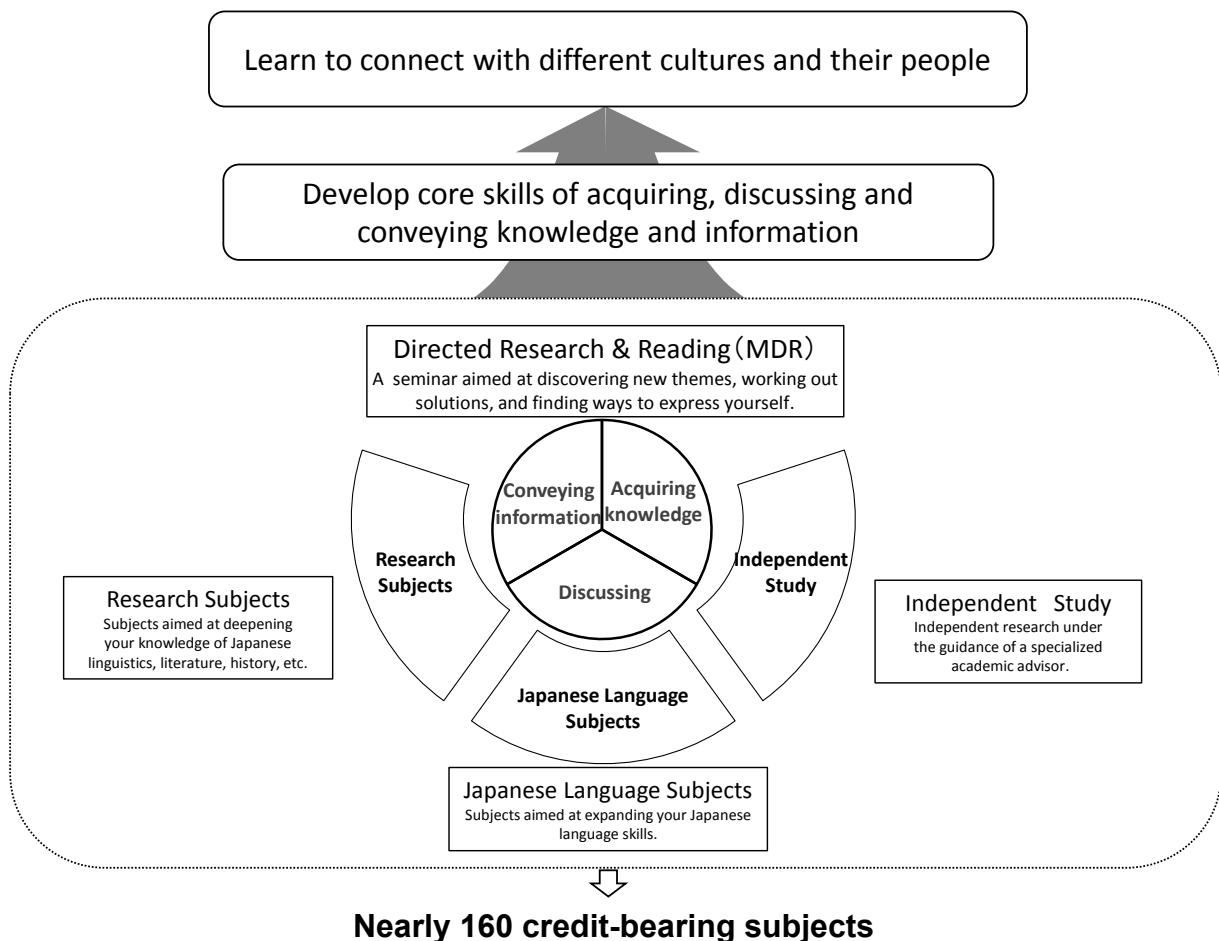

Course information

The Maple Program features four courses: Pre-intermediate, Intermediate, Upper-intermediate and Advanced. Students are placed in one of these four courses based on the results of a preliminary placement test.

Pre-intermediate Course

This course is designed for students evaluated to be within the CJLC's A2 range of Japanese language proficiency. Students learn Japanese language and culture through a range of activities conducted in "Directed Research & Reading" and further refine their grammar and vocabulary through the courses "Pre-intermediate Japanese α : Grammar & Vocabulary" and "Pre-intermediate Japanese β : Grammar & Vocabulary." Students may choose elective classes from both the Pre-intermediate and Intermediate course levels.

Intermediate Course

This course is designed for students evaluated to be within the CJLC's B1 range of Japanese language proficiency. Students learn Japanese language and culture through a range of activities conducted in "Directed Research & Reading" and further refine their grammar and vocabulary through the courses "Intermediate Japanese α : Grammar & Vocabulary" and "Intermediate Japanese β : Grammar & Vocabulary." In addition to classes offered at the Intermediate course level, students may take elective classes from both the Pre-intermediate and Upper-intermediate course levels.

Upper-intermediate Course

The Upper-intermediate Course is intended for students evaluated to be within the CJLC's B2 range of Japanese language proficiency. Students learn Japanese language and culture through a range of activities conducted in "Directed Research & Reading." In addition to classes offered at the Upper-intermediate course level, students may take elective classes from both the Intermediate and Advanced course levels.

Advanced Course

The Advanced Course is designed for students evaluated to be within the CJLC's C1 range of Japanese language proficiency. Students learn Japanese language and culture through a range of activities conducted in "Directed Research & Reading." Advanced Course students may choose elective classes from the Upper-intermediate and Advanced course levels.

2. Requirements for [M] Program Certificate

To complete the program, students must earn 30 or more credits in a year.

Category	Course	Credits	Requirements for completion
Required	Directed Research & Reading (MDR)	2 credits each	30 or more credits in a year
Electives	Research Subjects		
	Independent Study (MIS)		
Required (Pre-intermediate Japanese Course)	Pre-intermediate Japanese α : Grammar & Vocabulary (MGV)	4 credits	
	Pre-intermediate Japanese β : Grammar & Vocabulary (MGV)	2 credits	
Required (Intermediate Japanese Course)	Intermediate Japanese α : Grammar & Vocabulary (MGV)	4 credits	
	Intermediate Japanese β : Grammar & Vocabulary (MGV)	2 credits	
Electives	Japanese Language Subjects	1 credit each	

※ With their academic advisor's permission, students may substitute an elective course for Pre-intermediate Japanese α/β : Grammar & Vocabulary and Intermediate Japanese α/β : Grammar & Vocabulary.

3. Outline of Subjects

The Maple Program offers the following subjects: Directed Research & Reading (MDR), Japanese Language Subjects (L), Pre-Intermediate Japanese α/β : Grammar & Vocabulary (MGV), Intermediate Japanese α/β : Grammar & Vocabulary (MGV), Research Subjects in Japanese Studies (R), and Independent Study (MIS).

3-1. Required Subjects

All Maple Program students are required to take “Directed Research & Reading.” Students in the Pre- intermediate Course or Intermediate Course are additionally required to take “Pre-intermediate Japanese (α/β): Grammar & Vocabulary” or “Intermediate Japanese (α/β): Grammar & Vocabulary.”

① **【Directed Research & Reading】 (MDR)**

This seminar stimulates comprehensive understanding of Japanese language and culture. By experiencing Japanese culture and society first-hand by going on field trips, and by participating in project-based learning guided by teaching assistants (graduate students), you will come closer to this seminar’s ultimate goal: a comprehensive understanding of Japanese language, culture, and society. To ensure effective and smooth communication, we will focus on the development of three key skills: acquiring knowledge, conveying information, and discussion.

② **【Pre-intermediate Japanese α/β : Grammar & Vocabulary】 (MGV)**

These courses are for students evaluated to be within the CJLC’s A2 range of Japanese language proficiency. The goal of these courses is to improve students’ knowledge of grammar and vocabulary as well as increase their range of practical fluency. Based on the results of a placement examination, students will be required to take either both Pre-intermediate Japanese α (4 units per week) and Pre-intermediate Japanese β (2 units per week), or Pre-intermediate Japanese α alone.

③ **【Intermediate Japanese α/β : Grammar & Vocabulary】 (MGV)**

These courses are for students evaluated to be within the CJLC’s B1 range of Japanese language proficiency. The goal of these courses is to improve students’ knowledge of grammar and vocabulary as well as increase their range of practical fluency. Based on the results of a placement examination, students will be required to take either both Intermediate Japanese α (4 units per week) and Intermediate Japanese β (2 units per week), or Intermediate Japanese α alone.

3-2. Electives

There are three categories of elective class: ① **【Japanese Language Subjects】**, ② **【Research Subjects】**, and ③ **【Independent Study】**.

For detailed information on classes available each semester, please refer to List of Classes.

① **【Japanese Language Subjects】**

Participating students select from a broad range of elective subjects matched to their individual proficiency level. These include Reading (RDG), Listening (LIS), Writing (WRT), Speaking (SPK), Grammar & Vocabulary (GV), and Kanji & Vocabulary (KV) and are offered at the Pre-intermediate, Intermediate, Upper-intermediate and Advanced course levels.

Japanese Pre-intermediate Reading (RDG)

For A2 students who can:

- understand the Japanese alphabet and basic passages about daily-life situations (for example: pamphlets, schedules, menus, short e-mails, and private letters).

Japanese Pre-intermediate Listening (LIS)

For A2 students who can:

- comprehend audio in daily situations, such as simple short messages or announcements.

Japanese Pre-intermediate Writing (WRT)

For A2 students who can:

- write short messages or memos on daily matters;
- write brief private e-mails.

Japanese Pre-intermediate Speaking (SPK)

For A2 students who can:

- explain daily matters using elementary words, phrases and sentences;
- conduct brief social exchanges with others.

Japanese Pre-intermediate Grammar & Vocabulary (GV)

For A2 students who can:

- understand basic, commonly-used words within elementary vocabulary;
- understand expressions written in basic sentence patterns.

Japanese Pre-intermediate Kanji & Vocabulary (KV)

For A2 students who can:

- read and write basic kanji commonly-used in daily life;
- understand basic and commonly-used kanji expressions.

Japanese Intermediate Reading (RDG)

For B1 students who can:

- comprehend passages written about daily matters or a topic of their interest, for example, newspaper articles or private letter exchanges.

Japanese Intermediate Listening (LIS)

For B1 students who can:

- comprehend audio about daily matters or a topic of their interest, such as weather forecasts or train station announcements.

Japanese Intermediate Writing (WRT)

For B1 students who can:

- write a short essay about their daily life or a topic of their interest;
- write a short letter or e-mail;
- write a cohesive text using basic words and expressions.

Japanese Intermediate Speaking (SPK)

For B1 students who can:

- make a speech about their daily life or a topic of their interest while using tense correctly;
- express their views using subordinate sentences;
- participate in one-to-one conversation;
- pronounce words without causing misunderstandings.

Japanese Intermediate Grammar & Vocabulary (GV)

For B1 students who can:

- understand most elementary vocabulary;
- understand expressions using basic sentence patterns.

Japanese Intermediate Kanji & Vocabulary (KV)

For B1 students who can:

- read and write basic kanji;
- understand basic kanji expressions.

Japanese Upper-intermediate Reading (RDG)

For B2 students who can:

- understand somewhat technical contents within their field of specialty, including introductory textbooks or lecture materials;
- read modern novels;
- infer the meaning of an unfamiliar word;
- read and understand the stance and opinion of the author.

Japanese Upper-intermediate Listening (LIS)

For B2 students who can:

- understand somewhat technical contents in a long conversation or a lecture within their field of specialty;
- understand news, broadcasts, current events or movies;
- infer the meaning of an unfamiliar word.

Japanese Upper-intermediate Writing (WRT)

For B2 students who can:

- write a report relating to their field of specialty;
- write an article or a report given enough time;
- distinguish fact from their own opinion;
- create paragraphs while considering essay structure;
- write a cohesive text.

Japanese Upper-intermediate Speaking (SPK)

For B2 students who can:

- present a speech about their field of specialty clearly and in detail;
- present their research findings with enough preparation;
- distinguish fact from their own opinion;
- actively engage in a conversation;
- speak fluently to a certain extent.

Japanese Upper-intermediate Grammar & Vocabulary (GV)

For B2 students who can:

- understand fundamental vocabulary relating to their field of specialty;
- understand expressions using somewhat high-level sentence patterns.

Japanese Upper-intermediate Kanji & Vocabulary (KV)

For B2 students who can:

- read and write somewhat high-level commonly-used kanji;
- understand commonly-used kanji expressions in addition to somewhat high-level kanji expressions within their field of specialty.

Japanese Advanced Reading (RDG)

For C1 students who can:

- understand texts from various fields written in standard Japanese;
- understand an introductory book even if it is not of their field of specialty;
- understand a technical book, an article or lecture material of a high level if it is of their field of specialty;
- understand the part of a text emphasized by the author.

Japanese Advanced Listening (LIS)

For C1 students who can:

- understand topics from various fields spoken in standard Japanese;
- understand a basic-level lecture even if it is not of their field of specialty;
- understand a higher-level lecture of their field of specialty;
- enjoy most TV programs or movies without any special effort;
- grasp the flow of a conversation with more than three participants.

Japanese Advanced Writing (WRT)

For C1 students who can:

- write a somewhat technical article or report about subjects from various fields;
- write a cohesive text;
- put an emphasis on their opinion in the text.

Japanese Advanced Speaking (SPK)

For C1 students who can:

- present a speech containing somewhat technical content about subjects from various fields;
- coherently present an argument from a single perspective;
- participate in conversations while cooperating with other participants;
- express themselves fluently.

Japanese Advanced Grammar & Vocabulary (GV)

For C1 students who:

- understand fundamental vocabulary within a variety of fields;
- understand the highest level sentence patterns necessary for any social situation.

Japanese Advanced Kanji & Vocabulary (KV)

For C1 students who:

- read and write almost all kanji used in daily life;
- understand almost all kanji expressions necessary for conducting any social situation;
- understand higher-level kanji expressions if it is of their field of specialty.

② **【Research Subjects】**

These subjects offer students the opportunity to pursue academic knowledge in their field. Through language and language education, as well as the study of literature, history, sociology and Japanese thought, students acquire a contrastive perspective of Japanese culture and discuss content learned in class. Classes are conducted in Japanese, with some classes conducted in English.

The following classes are offered: Japanese Linguistics, Japanese Language Education, Japanese Thought, Japanese History, Japanese Literature, Japanese Contemporary Culture, and Japanese Social Sciences.

For each Research Subject, there is an introductory course (“Introduction to XX”) that provides foundational knowledge in the subject concerned while taking into consideration students’ practical ability.

Japanese Linguistics (LIN)

Students analyze various characteristics of the Japanese language from a linguistic perspective. This involves the subfields of phonetics and phonology, morphology and syntax, pragmatics and semantics, typology, contrastive linguistics, social linguistics, and the history of Japanese.

Japanese Language Education (EDU)

This subject provides students with the requisite knowledge and perspective used in examining various aspects of Japanese language education. This includes basic knowledge of Japanese language education, second language acquisition and language pedagogy. Students learn to apply knowledge from related fields such as linguistics and Japanese linguistics in order to deepen their understanding of language education.

Japanese Thought (THO)

This subject examines Japanese thought through disciplines such as religious studies, folkloristics, and cultural anthropology. Students investigate Japanese culture and society from a historical perspective, looking closely at aspects of traditional Japanese culture such as annual festivals and functions.

Japanese History (HIS)

This subject teaches Japanese history spanning from ancient to modern times. Students explore topics in Japanese society and Japanese culture through the lens of Japanese history. This includes cultural history, as well as practices like Japanese calligraphy and tea ceremony.

Japanese Literature (LIT)

This subject teaches Japanese classical literature, dating from the Nara period to the Edo period, as well as modern and contemporary literature, written from the Meiji period onward. This subject deals also with literary history and criticism, as well as traditional Japanese performing arts.

Japanese Contemporary Culture (CON)

This subject teaches contemporary and modern Japanese culture as well as research methodology. Students familiarize themselves with cultural characteristics, historical trends and current problems facing Japanese society. Knowledge of research methods used in sociology and comparative culture deepens students' understanding of cultural research.

Japanese Social Sciences (SOC)

This subject examines Japanese society from a sociological perspective, considering politics, economics and management, including discussion of international relations. Students deepen their understanding of Japanese society through investigations of current affairs and historical analyses.

③ 【Independent Study】 (MIS)

In Independent Study, students read and interpret primary sources they have gathered in Japan and conduct investigative research. Students acquire deeper knowledge of Japanese language and culture through self-directed data collection and analysis, under the guidance and instruction of a supervisor. In order to enroll in the course, students must pass a review based on document submission and an interview exam.

4. Extracurricular Activities

To improve students' Japanese language skills and to deepen their understanding of Japanese language, culture and society, the CJLC plans various activities on and off campus.

- (1) As part of Directed Research and Reading, educational field trips are scheduled for locations in the vicinity. These trips are intended to provide students with an immersive experience of Japanese society and culture.
- (2) The CJLC plans tours of places of interest for students to help them better understand Japanese history, folklore, economy and business management.
- (3) The CJLC also offers opportunities to view Japanese traditional performing arts, such as *kabuki* and *bunraku*, in order to help students deepen their understanding of Japanese art and culture.
- (4) To experience the culture of Japanese daily life, students may participate in the host family program and other events organized or introduced by Osaka University Center for International Education and Exchange (5th floor, Minoh Campus).

※ Various activities are organized in addition to those listed above. Detailed information will be posted on the bulletin board near the CJLC Office or CJLC Library Room.

じゅ ぎょう いち らん
授 業 一 覧

List of Classes

※^{じゅぎょう}授業^{くわ}の^{ないよう}詳しい内容は KOAN^みを見てください。
See KOAN for details of each subject.

M Code	J Code	Category	Day/Period	Program	Level	Type	種別	授業科目名	Instructor(s)	教員	サブタイトル/授業テーマ
1	390020	GV	Mon. 3	J/M/O	A2	Rec.	実習	J/M/O (A2) Japanese Language Subjects 日本語初級中級文法・語彙 (春夏)	TACHIKAWA	立川真紀絵	基本文型の整理と完成
								J/M/O (B1) Japanese Language Subjects 日本語実習科目			
2	390010	RDG	Mon. 1	J/M/O	B1	Rec.	実習	日本語中級読解 (春夏)	JIN	金珠	音読と理解の発展練習
3	390011	RDG	Thu. 5	J/M/O	B1	Rec.	実習	日本語中級読解 (春夏)	KIM	金吉任	速読の練習
4	390015	LIS	Wed. 2	J/M/O	B1	Rec.	実習	日本語中級聴解 (春夏)	HATANO	波多野吉徳	身の回りの日本語を聞く
5	390021	WRT	Thu. 3	J/M/O	B1	Rec.	実習	日本語中級文章表現 (春夏)	NAMBA	南場尚子	まとまりのある文章を書く
6	390025	SPK	Mon. 3	J/M/O	B1	Rec.	実習	日本語中級口頭表現 (春夏)	KYOTANI	京谷麻矢	スピーチ/プレゼンテーション
7	390026	SPK	Wed. 3	J/M/O	B1	Rec.	実習	日本語中級口頭表現 (春夏)	MIYAZAKI	宮崎さとみ	交渉会話・交流会話
8	390030	GV	Wed. 4	J/M/O	B1	Rec.	実習	日本語中級文法・語彙 (春夏)	DUONG,T	ズオン,T.	類似表現の整理と使い分け
9	390031	GV	Fri. 3	J/M/O	B1	Rec.	実習	日本語中級文法・語彙 (春夏)	MATSUOKA	松岡里奈	類似表現の整理と使い分け
10	390040	KV	Tue. 1	J/M/O	B1	Rec.	実習	日本語中級漢字・語彙 (春夏)	DUONG,T	ズオン,T.	語構成から学ぶ漢語
11	390041	KV	Thu. 4	J/M/O	B1	Rec.	実習	日本語中級漢字・語彙 (春夏)	KAI	甲斐朋子	時事問題の漢字語彙
								J/M/O (B2) Japanese Language Subjects 日本語実習科目			
12	390045	RDG	Mon. 4	J/M/O	B2	Rec.	実習	日本語中級読解 (春夏)	KAWASHIMA	川島信恵	専門性のある文章の読解
13	390046	RDG	Wed. 5	J/M/O	B2	Rec.	実習	日本語中級読解 (春夏)	HIROKAWA	廣川直幸	比較文学の読解の練習
14	390047	RDG	Thu. 4	J/M/O	B2	Rec.	実習	日本語中級読解 (春夏)	UEDA, A.	上田安希子	現代社会に関連した文章の読解
15	390048	RDG	Fri. 1	J/M/O	B2	Rec.	実習	日本語中級読解 (春夏)	SHINJO	新庄あいみ	概説等学習用書籍の速読ストラテジー
16	390055	LIS	Tue. 1	J/M/O	B2	Rec.	実習	日本語中級聴解 (春夏)	YAMASHITA	山下春菜	様々なタイプの話者による独話・対話の聴解
17	390056	LIS	Wed. 3	J/M/O	B2	Rec.	実習	日本語中級聴解 (春夏)	WADA	和田亜矢子	日本人の会話を聞く技術
18	390057	LIS	Thu. 2	J/M/O	B2	Rec.	実習	日本語中級聴解 (春夏)	NAMBA	南場尚子	複数人の会話を聞く技術
19	390058	LIS	Thu. 5	J/M/O	B2	Rec.	実習	日本語中級聴解 (春夏)	ATSUTA	熱田万美	時事的な話題の独話・対話の聴解
20	390065	WRT	Mon. 1	J/M/O	B2	Rec.	実習	日本語中級文章表現 (春夏)	ABE	安部陽子	自然な日本語を書くためのトレーニング
21	390066	WRT	Wed. 4	J/M/O	B2	Rec.	実習	日本語中級文章表現 (春夏)	KOMORI	小森万里	アカデミック・ライティングの基礎
22	390067	WRT	Thu. 2	J/M/O	B2	Rec.	実習	日本語中級文章表現 (春夏)	NONAKA	野中篤	レポート・小論文の日本語
23	390068	WRT	Fri. 1	J/M/O	B2	Rec.	実習	日本語中級文章表現 (春夏)	FUJIMOTO	藤本憲志	様々な文書作成の基本
24	390075	SPK	Mon. 1	J/M/O	B2	Rec.	実習	日本語中級口頭表現 (春夏)	MATSUSHIMA	松島弘枝	交渉会話
25	390076	SPK	Wed. 1	J/M/O	B2	Rec.	実習	日本語中級口頭表現 (春夏)	TANAKA, M.	田中舞	描写・説明
26	390077	SPK	Thu. 3	J/M/O	B2	Rec.	実習	日本語中級口頭表現 (春夏)	SANADA	真田悠美	交流会話
27	390078	SPK	Fri. 4	J/M/O	B2	Rec.	実習	日本語中級口頭表現 (春夏)	ATSUTA	熱田万美	描写・説明
28	390085	GV	Tue. 2	J/M/O	B2	Rec.	実習	日本語中級文法・語彙 (春夏)	KASAMATSU	笠松瑞子	日本事情から見える言葉
29	390086	GV	Wed. 1	J/M/O	B2	Rec.	実習	日本語中級文法・語彙 (春夏)	UEDA, M.	植田みのり	文体によって異なる表現形式
30	390087	GV	Thu. 1	J/M/O	B2	Rec.	実習	日本語中級文法・語彙 (春夏)	FUJII,C.	藤井千枝	文章を通して学ぶ表現・語彙
31	390088	GV	Fri. 3	J/M/O	B2	Rec.	実習	日本語中級文法・語彙 (春夏)	ATARASHI	新聖子	接続表現・副詞句
32	390095	KV	Mon. 2	J/M/O	B2	Rec.	実習	日本語中級漢字・語彙 (春夏)	ABE	安部陽子	慣用表現で学ぶ漢字語彙
33	390096	KV	Wed. 2	J/M/O	B2	Rec.	実習	日本語中級漢字・語彙 (春夏)	UEDA, M.	植田みのり	関連語を通して学ぶ漢字語彙
34	390097	KV	Thu. 1	J/M/O	B2	Rec.	実習	日本語中級漢字・語彙 (春夏)	TATSUMI	辰巳委子	論文やレポートの漢字語彙
35	390098	KV	Fri. 2	J/M/O	B2	Rec.	実習	日本語中級漢字・語彙 (春夏)	FURUTA	古田朋子	漢語と和語での類義表現

M Code	J Code	Category	Day/Period	Program	Level	Type	種別	授業科目名	Instructor(s)	教員	サブタイトル/授業テーマ
				J/M/O (C1) Japanese Language Subjects 日本語実習科目							
36	390105	RDG	Wed. 4	J/M/O	C1	Rec.	実習	日本語上級読解(春夏)	NAKATA	中田一志	日本語学の文章の読解
37	390106	RDG	Thu. 1	J/M/O	C1	Rec.	実習	日本語上級読解(春夏)	NONAKA	野中篤	異文化比較・異言語比較に関する読解
38	390107	RDG	Thu. 5	J/M/O	C1	Rec.	実習	日本語上級読解(春夏)	OKUNO	奥野紗衣	現代社会に関連した文章の読解
39	390108	RDG	Fri. 1	J/M/O	C1	Rec.	実習	日本語上級読解(春夏)	FURUTA	古田朋子	専門性のある文章の読解
40	390110	LIS	Mon. 1	J/M/O	C1	Rec.	実習	日本語上級聴解(春夏)	CHIDA	千田愛	日本語・日本文化を題材とした対話や独話の聴解
41	390111	LIS	Mon. 5	J/M/O	C1	Rec.	実習	日本語上級聴解(春夏)	IWADE	岩出雪乃	時事的な話題の独話・対話の詳細な聴解
42	390114	LIS	Tue. 1	J/M/O	C1	Rec.	実習	日本語上級聴解(春夏)	FURUKAWA	古川由理子	日本社会を題材とした独話・対話の聴解
43	390115	LIS	Wed. 2	J/M/O	C1	Rec.	実習	日本語上級聴解(春夏)	IWAI, Y.	岩井康雄	種教人の会話を聞く技術
44	390112	LIS	Wed. 3	J/M/O	C1	Rec.	実習	日本語上級聴解(春夏)	HATANO	波多野吉徳	雑談を聞く技術
45	390113	LIS	Thu. 5	J/M/O	C1	Rec.	実習	日本語上級聴解(春夏)	TAKATSUKI	高月喜美	時事的な話題の独話・対話の詳細な聴解
46	390121	WRT	Mon. 2	J/M/O	C1	Rec.	実習	日本語上級文章表現(春夏)	CHIDA	千田愛	書くために必要なこと
47	390122	WRT	Mon. 4	J/M/O	C1	Rec.	実習	日本語上級文章表現(春夏)	BABA	馬場裕子	学術的な文章を書くために必要なこと
48	390123	WRT	Wed. 4	J/M/O	C1	Rec.	実習	日本語上級文章表現(春夏)	HIROKAWA	廣川直幸	書評を書く
49	390124	WRT	Thu. 2	J/M/O	C1	Rec.	実習	日本語上級文章表現(春夏)	TANAKA, S.	田中里美	小論文・レポート作成の技法
50	390125	WRT	Thu. 4	J/M/O	C1	Rec.	実習	日本語上級文章表現(春夏)	YAMAMOTO, K.	山本一也	映像を見て、文章を書く
51	390126	WRT	Fri. 2	J/M/O	C1	Rec.	実習	日本語上級文章表現(春夏)	SUZUKI, Y.	鈴木由香里	書くために必要なこと
52	390130	SPK	Mon. 1	J/M/O	C1	Rec.	実習	日本語上級口頭表現(春夏)	TANAKA, Y.	田中泰子	ビジネス・コミュニケーション
53	390131	SPK	Mon. 4	J/M/O	C1	Rec.	実習	日本語上級口頭表現(春夏)	IWADE	岩出雪乃	交流会話
54	390132	SPK	Tue. 2	J/M/O	C1	Rec.	実習	日本語上級口頭表現(春夏)	YAMASHITA	山下春菜	スピーチ/プレゼンテーション
55	390133	SPK	Thu. 2	J/M/O	C1	Rec.	実習	日本語上級口頭表現(春夏)	HATANO	波多野吉徳	議論
56	390134	SPK	Fri. 2	J/M/O	C1	Rec.	実習	日本語上級口頭表現(春夏)	FUJIMOTO	藤本憲志	交渉会話
57	390135	SPK	Fri. 3	J/M/O	C1	Rec.	実習	日本語上級口頭表現(春夏)	FUJII, M.	藤井みゆき	議論
58	390140	GV	Mon. 2	J/M/O	C1	Rec.	実習	日本語上級文法・語彙(春夏)	MATSUSHIMA	松島弘枝	慣用表現
59	390141	GV	Mon. 5	J/M/O	C1	Rec.	実習	日本語上級文法・語彙(春夏)	KAWASHIMA	川島信恵	名言・名句
60	390142	GV	Tue. 2	J/M/O	C1	Rec.	実習	日本語上級文法・語彙(春夏)	FURUKAWA	古川由理子	文体によって異なる表現形式
61	390143	GV	Wed. 2	J/M/O	C1	Rec.	実習	日本語上級文法・語彙(春夏)	TANAKA, M.	田中舞	時事日本語
62	390144	GV	Wed. 3	J/M/O	C1	Rec.	実習	日本語上級文法・語彙(春夏)	NAKATA	中田一志	日本事情から見える言葉
63	390145	GV	Thu. 4	J/M/O	C1	Rec.	実習	日本語上級文法・語彙(春夏)	ATSUTA	熱田万美	役割語
64	390150	KV	Mon. 3	J/M/O	C1	Rec.	実習	日本語上級漢字・語彙(春夏)	CHIDA	千田愛	新聞で用いられる漢語
65	390151	KV	Tue. 1	J/M/O	C1	Rec.	実習	日本語上級漢字・語彙(春夏)	KASAMATSU	笠松瑞子	同音異字語
66	390153	KV	Wed. 1	J/M/O	C1	Rec.	実習	日本語上級漢字・語彙(春夏)	KITAGAWA	北川美香	新聞で用いられる漢語
67	390154	KV	Wed. 3	J/M/O	C1	Rec.	実習	日本語上級漢字・語彙(春夏)	KOGA	古賀静香	漢語の類義表現
68	390155	KV	Thu. 1	J/M/O	C1	Rec.	実習	日本語上級漢字・語彙(春夏)	TANAKA, S.	田中里美	文脈で学ぶ漢字語彙
69	390156	KV	Thu. 3	J/M/O	C1	Rec.	実習	日本語上級漢字・語彙(春夏)	MITO	三登由利子	漢字で読み解く日本

M Code	J Code	Category	Day/Period	Program	Level	Type	種別	授業科目名	Instructor(s)	教員	サブタイトル/授業テーマ
70	390167	LIN	Mon. 5	J/M/O	B2	Lec./Sem.	講義/演習	日本語学研究基礎(春夏)2	IMAI	今井忍	意味論
71	390168	LIN	Wed. 4	J/M/O	B2	Lec./Sem.	講義/演習	日本語学研究基礎(春夏)3	IWAI, Y.	岩井康雄	言語学概論
72	390240	EDU	Wed. 2	J/M/O	B2	Lec./Sem.	講義/演習	日本語教育学研究基礎(春夏)1	KOMORI	小森万里	日本語教育学概論
73	390241	EDU	Fri. 3	J/M/O	B2	Lec./Sem.	講義/演習	日本語教育学研究基礎(春夏)2	SUZUKI, Y.	鈴木由香里	文法・語彙の指導
74	390185	THO	Tue. 1	J/M/O	B2	Lec./Sem.	講義/演習	日本思想文化学研究基礎(春夏)1	SHIBATA etc.	柴田芳成ほか	日本文化入門
75	390191	HIS	Mon. 3	J/M/O	B2	Lec./Sem.	講義/演習	日本歴史文化学研究基礎(春夏)2	HISAOKA	久岡明穂	茶道
76	390192	HIS	Mon. 5	J/M/O	B2	Lec./Sem.	講義/演習	日本歴史文化学研究基礎(春夏)3	FUKUMITSU	福光由布	書道
77	390193	HIS	Tue. 2	J/M/O	B2	Lec./Sem.	講義/演習	日本歴史文化学研究基礎(春夏)4	SANO, M.	佐野方郁	日本史入門
78	390194	HIS	Thu. 3	J/M/O	B2	Lec./Sem.	講義/演習	日本歴史文化学研究基礎(春夏)5	INOMO	井面舞	日本美術史
79	390195	HIS	Fri. 2	J/M/O	B2	Lec./Sem.	講義/演習	日本歴史文化学研究基礎(春夏)6	SATO, S.	佐藤早紀子	日本文化史入門
80	390205	LIT	Mon. 2	J/M/O	B2	Lec./Sem.	講義/演習	日本文献文化学研究基礎(春夏)1	HISAOKA	久岡明穂	日本近現代文学
81	390206	LIT	Mon. 3	J/M/O	B2	Lec./Sem.	講義/演習	日本文献文化学研究基礎(春夏)2	GONOJI	五之治昌比呂	日本近現代文学
82	390207	LIT	Fri. 4	J/M/O	B2	Lec./Sem.	講義/演習	日本文献文化学研究基礎(春夏)3	SHIBATA	柴田芳成	日本古典芸能
83	390226	CON	Mon. 4	J/M/O	B2	Lec./Sem.	講義/演習	日本近現代文化学研究基礎(春夏)2	TSUNODA	角田燎	社会学
84	390227	CON	Wed. 3	J/M/O	B2	Lec./Sem.	講義/演習	日本近現代文化学研究基礎(春夏)3	IWAI, S.	岩井茂樹	比較文化学
85	390228	CON	Wed. 5	J/M/O	B2	Lec./Sem.	講義/演習	日本近現代文化学研究基礎(春夏)4	OTANI	大谷晋平	日本の映画
86	390229	CON	Thu. 4	J/M/O	B2	Lec./Sem.	講義/演習	日本近現代文化学研究基礎(春夏)5	KOBAYASHI, S.	小林翔	マンガ・アニメ学
87	390430	CON	Thu. 5	J/M/O	B2	Lec./Sem.	講義/演習	日本近現代文化学研究基礎(春夏)6	PENG	彭永成	日本のメディア文化
88	390235	SOC	Mon. 5	J/M/O	B2	Lec./Sem.	講義/演習	日本社会文化学研究基礎(春夏)1	HAYASHI, H.	林光	日本政治学

M Code	J Code	Category	Day/Period	Program	Level	Type	種別	授業科目名	Instructor(s)	教員	サブタイトル/授業テーマ
J/M/O (C1) Research Subjects 研究科目											
89	390160	LIN	Mon. 4	J/M/O	C1	Lec./Sem.	講義/演習	日本語学研究(春夏)1	YAMAKAWA	山川太	統語論
90	390161	LIN	Tue. 2	J/M/O	C1	Lec./Sem.	講義/演習	日本語学研究(春夏)2	NAKATA	中田一志	語用論
91	390162	LIN	Wed. 5	J/M/O	C1	Lec./Sem.	講義/演習	日本語学研究(春夏)3	SHOJI	莊司育子	形態論
92	390163	LIN	Thu. 3	J/M/O	C1	Lec./Sem.	講義/演習	日本語学研究(春夏)4	CIOLCAR.	チオルカ, R.	日本語学論文講読
93	390175	EDU	Mon. 4	J/M/O	C1	Lec./Sem.	講義/演習	日本語教育学研究(春夏)1	FUJHIRA	藤平愛美	ICTを使った日本語教育
94	390176	EDU	Wed. 4	J/M/O	C1	Lec./Sem.	講義/演習	日本語教育学研究(春夏)2	TAKAI	高井美穂	話しことばの指導
95	390180	THO	Mon. 2	J/M/O	C1	Lec./Sem.	講義/演習	日本思想文化学研究(春夏)1	MOTOBAYASHI	本林靖久	日本民俗文化論
96	390181	THO	Wed. 5	J/M/O	C1	Lec./Sem.	講義/演習	日本思想文化学研究(春夏)2	BURENINA	ブレニナ, Y.	日本思想文化論
97	390182	THO	Fri. 3	J/M/O	C1	Lec./Sem.	講義/演習	日本思想文化学研究(春夏)3	WATANABE, C.	渡邊親文	日本宗教思想論
98	390183	THO	Fri. 4	J/M/O	C1	Lec./Sem.	講義/演習	日本思想文化学研究(春夏)4	ONISHI	大西薫	日本宗教文化論
99	390196	HIS	Mon. 3	J/M/O	C1	Lec./Sem.	講義/演習	日本歴史文化学研究(春夏)1	SANO, M.	佐野方郁	日本現代史
100	390197	HIS	Thu. 1	J/M/O	C1	Lec./Sem.	講義/演習	日本歴史文化学研究(春夏)2	TAIRA	平良聡弘	日本近代史
101	390198	HIS	Thu. 3	J/M/O	C1	Lec./Sem.	講義/演習	日本歴史文化学研究(春夏)3	YAMAMOTO, K.	山本一也	日本中世史
102	390199	HIS	Thu. 4	J/M/O	C1	Lec./Sem.	講義/演習	日本歴史文化学研究(春夏)4	INOMO	井面舞	日本美術史
103	390300	HIS	Fri. 4	J/M/O	C1	Lec./Sem.	講義/演習	日本歴史文化学研究(春夏)5	KOYAMA	小山有子	日本服装史
104	390200	LIT	Wed. 2	J/M/O	C1	Lec./Sem.	講義/演習	日本文献文化学研究(春夏)1	MIZUNO	水野亜紀子	日本近現代文学
105	390201	LIT	Fri. 1	J/M/O	C1	Lec./Sem.	講義/演習	日本文献文化学研究(春夏)2	SATO, S.	佐藤早紀子	日本古典文学
106	390202	LIT	Fri. 3	J/M/O	C1	Lec./Sem.	講義/演習	日本文献文化学研究(春夏)3	SHIBATA	柴田芳成	日本古典文学
107	390220	CON	Mon. 1	J/M/O	C1	Lec./Sem.	講義/演習	日本近現代文化学研究(春夏)1	MOTOBAYASHI	本林靖久	日本現代社会
108	390221	CON	Tue. 2	J/M/O	C1	Lec./Sem.	講義/演習	日本近現代文化学研究(春夏)2	SETO	瀬戸麗	教育社会学
109	390222	CON	Wed. 1	J/M/O	C1	Lec./Sem.	講義/演習	日本近現代文化学研究(春夏)3	BEREZIKOVA	ベレジコワ, T.	日本近現代文化史
110	390223	CON	Fri. 3	J/M/O	C1	Lec./Sem.	講義/演習	日本近現代文化学研究(春夏)4	KOYAMA	小山有子	女性学
111	390230	SOC	Wed. 1	J/M/O	C1	Lec./Sem.	講義/演習	日本社会文化学研究(春夏)1	KUBOTA	久保田ゆかり	国際関係
112	390231	SOC	Wed. 3	J/M/O	C1	Lec./Sem.	講義/演習	日本社会文化学研究(春夏)2	IMURA	井村美根	日本経営学
113	390232	SOC	Fri. 4	J/M/O	C1	Lec./Sem.	講義/演習	日本社会文化学研究(春夏)3	ITO	伊藤敏雄	日本経済学

M Code	J Code	Category	Day・Period	Program	Level	Type	種別	授業科目名	Instructor(s)	教員	サブタイトル/授業テーマ
M (B1) Japanese Language Subjects 日本語実習科目 (MGV)											
150	390001	MGVα1	Mon. 2	M	B1	Rec.	実習	TANAKA, Y.	田中 泰子		
151	390001	MGVα1	Tue. 2	M	B1	Rec.	実習	TAKAI	高井美穂		
152	390001	MGVα1	Thu. 2	M	B1	Rec.	実習	FUJII.C.	藤井千枝		
153	390001	MGVα1	Fri. 2	M	B1	Rec.	実習	HIGUCHI	樋口 尊子		
154	390002	MGVα2	Mon. 2	M	B1	Rec.	実習	KYOTANI	京谷 麻矢		
155	390002	MGVα2	Tue. 2	M	B1	Rec.	実習	TACHIKAWA	立川 真紀絵		
156	390002	MGVα2	Thu. 2	M	B1	Rec.	実習	TATSUMI	辰巳 委子		
157	390002	MGVα2	Fri. 2	M	B1	Rec.	実習	FUJII.M.	藤井みゆき		
Directed Research and Reading Subjects 日本語日本文化専門演習 (MDR)											
158	390260	MDR	Tue. 3	M	—	Sem.	演習	IWAI, S.	岩井 茂樹		
159	390261	MDR	Tue. 3	M	—	Sem.	演習	KOMORI	小森 万里		
160	390262	MDR	Tue. 3	M	—	Sem.	演習	TAKAI	高井美穂		
161	390263	MDR	Tue. 3	M	—	Sem.	演習	TACHIKAWA	立川 真紀絵		
162	390264	MDR	Tue. 3	M	—	Sem.	演習	FUJIIHARA	藤平 愛美		
163	390265	MDR	Tue. 3	M	—	Sem.	演習	MATSUOKA	松岡 里奈		
Independent Studies Subjects 自主研究科目 (MIS)											
164	390250	MIS	Tue. 5	M	—	Sem.	演習	MIZUNO	水野 亜紀子		
165	390251	MIS	Tue. 5	M	—	Sem.	演習	IWAI, S.	岩井 茂樹		
M/O (一) Research Subjects in English 英語による研究科目											
166	390166	LIN	Wed. 5	M/O	—	Lec./Sem.	講義/演習	VRBOVSKY	ヴルボフスキ, M.	語用論入門	
167	390190	HIS	Mon. 4	M/O	—	Lec./Sem.	講義/演習	FUKUMITSU	福光 由布	書道	
168	390225	CON	Fri. 4	M/O	—	Lec./Sem.	講義/演習	WATANABE.C.	渡邊 親文	日本現代社会	

じ かん わり
時 間 割

Weekly Schedule

令和6年度 春～夏学期 時間割表

	月	火	水	木	金
I	U1 必修 金田英里 U2 必修 島千尋 U3 必修 宮崎さとみ U4 必修 石橋鈴央 U5 必修 林希和子 U6 必修 荒島和子 U7 必修 大塚淳子 U8 必修 辰巳委子 B1 RDG 金珠 B2 WRT 安部陽子 SPK 秋島弘枝 LIS 千田愛子 SPK 田中森子 CON 本林靖久	U1 必修 近藤正憲 U2 必修 小林可奈子 U3 必修 福島薫 U4 必修 矢田まり子 U5 必修 廣坂直子 U6 必修 神夏磯晴香 U7 必修 新井潤 U8 必修 大塚淳子 B1 KV トアノ.T. B2 LIS 山下春菜 LIS 古川由理子 KV 笠松 瑞子 THO 柴田 芳成ほか	U 必修 乾逸子 U 必修 林和子 U4 必修 山澤園子 U5 必修 京谷麻矢 U6 必修 鈴木真理子 U7 必修 宮崎さとみ U8 必修 古賀静香 SPK 田中舞 B2 J/M/0 植田みほり B1 KV 北川美香 CON ベレシニコワ.T. SOG 久保田ゆかり JWRT 山下春菜	U1 必修 菅根子 U2 必修 荒島和子 U3 必修 真下恭子 U4 必修 福富奈美 U5 必修 日比伊奈穂 U6 必修 中村正美 U7 必修 松本恵美子 U8 必修 藤井千枝 J/M/0 藤本憲志 B2 KV 辰巳委子 B1 RDG 野中篤 RDG 田中里美 LIS 平良総弘	U1 必修 日比伊奈穂 U2 必修 山本幸枝 U3 必修 植田みほり U4 必修 鈴木真理子 U5 必修 井手恭子 U6 必修 中嶋伸子 U7 必修 林希和子 U8 必修 藤本憲志 B2 WRT 新庄あいみ B1 RDG 藤本憲志 B2 RDG 古田朋子 LIS 佐藤早紀子 JWRT 古川由理子
II	U1 必修 金田英里 U2 必修 島千尋 U3 必修 宮崎さとみ U4 必修 石橋鈴央 U5 必修 林希和子 U6 必修 荒島和子 U7 必修 大塚淳子 U8 必修 辰巳委子 B1 RDG 金珠 B2 WRT 安部陽子 SPK 秋島弘枝 LIS 千田愛子 SPK 田中森子 CON 本林靖久	U1 必修 近藤正憲 U2 必修 小林可奈子 U3 必修 福島薫 U4 必修 矢田まり子 U5 必修 廣坂直子 U6 必修 神夏磯晴香 U7 必修 新井潤 U8 必修 大塚淳子 B1 KV トアノ.T. B2 LIS 山下春菜 LIS 古川由理子 KV 笠松 瑞子 THO 柴田 芳成ほか	U 必修 乾逸子 U 必修 林和子 U4 必修 山澤園子 U5 必修 京谷麻矢 U6 必修 鈴木真理子 U7 必修 宮崎さとみ U8 必修 古賀静香 SPK 田中舞 B2 J/M/0 植田みほり B1 KV 北川美香 CON ベレシニコワ.T. SOG 久保田ゆかり JWRT 山下春菜	U1 必修 菅根子 U2 必修 荒島和子 U3 必修 真下恭子 U4 必修 福富奈美 U5 必修 日比伊奈穂 U6 必修 中村正美 U7 必修 松本恵美子 U8 必修 藤井千枝 J/M/0 藤本憲志 B2 KV 辰巳委子 B1 RDG 野中篤 RDG 田中里美 LIS 平良総弘	U1 必修 日比伊奈穂 U2 必修 山本幸枝 U3 必修 植田みほり U4 必修 鈴木真理子 U5 必修 井手恭子 U6 必修 中嶋伸子 U7 必修 林希和子 U8 必修 藤本憲志 B2 WRT 新庄あいみ B1 RDG 藤本憲志 B2 RDG 古田朋子 LIS 佐藤早紀子 JWRT 古川由理子

月	火	水	木	金
立川真紀絵 京谷麻矢 千田愛 久岡明徳 佐野方都 五之治昌比呂 石橋玲央 金田英里 田中泰子	今井忍 松浦幸祐 中谷真也 笹川史絵 日比伊奈穂 松村薫子 山川太 岩井茂樹 小森万里 高井美穂 立川真紀絵 藤平愛美 松岡里奈 岩井康雄 岸田泰浩 佐野方都 柴田芳成 中田育子 志 村田真事 五之治昌比呂 水野真紀子	後藤祐晃 滝澤温彦 小川洋子 佐藤透 外川直子 根村英克 半田克巳 宮崎さとみ 和田亜矢子 波多野吉徳 中田一志 古賀静香 岩井茂樹 井村美根 鈴木真理子	五木工 高橋甫宗 藤健太 三口雄大 宮田繁 森田健 山田智宏 南陽尚子 真田聡美 真由利子 チョルカ、R. 井面舞 山本一也 真下恭子	鳥海幸四郎 内藤幸人 中山尊量 原田俊郎 本間健二 松本有正 御厨正博 松岡里奈 新聖子 藤井みゆき 渡邊綴文 柴田芳成 小山有子 鈴木田香里 樋口尊子
川鷲信恵 馬場裕子 岩出雪乃 山川太 藤平愛美 福光由布 角田僚	今井忍 松浦幸祐 中谷真也 笹川史絵 日比伊奈穂 松村薫子 山川太 岩井茂樹 小森万里 高井美穂 立川真紀絵 水野真紀子 村田真実 藤平愛美	後藤祐晃 滝澤温彦 小川洋子 佐藤透 外川直子 根村英克 半田克巳 オオノ、I. 小森万里 中田一志 廣川直幸 岩井康雄 高井美穂 和田亜矢子	五木工 高橋甫宗 藤健太 三口雄大 宮田繁 森田健 山田智宏 申愛朋子 上田安希子 山本一也 熱田万美 井面舞 小林翔 奥野紗衣	高海幸四郎 内藤幸人 中山尊量 原田俊郎 本間健二 松本有正 御厨正博 熱田万美 大西薫 柴田芳成 渡邊綴文 伊藤敏雄 小山有子 新聖子
荘司育子 村田真実 岩出雪乃 川鷲信恵 今井忍 福光由布 林光	丸ボウスキ、M. 若井康雄 荘司育子 村田真実 水野真紀子 五之治昌比呂 松村薫子 山川太 今井忍 松浦幸祐	廣川直幸 荘司育子 ヴルボウスキ、M. プレニナ、Y. 大谷晋平	金 吉任 熱田万美 奥野紗衣 高月 喜美 彭永成	

Spring and Summer Terms, 2024

Monday			Tuesday			Wednesday			Thursday			Friday		
Rq U1	UJPN	KANEDA	Rq U1	UJPN	KONDO	Rq U	UJPN	INUJI	Rq U1	UJPN	KAN	Rq U	UJPN	HIBI
Rq U2	UJPN	SHIMA	Rq U2	UJPN	KOBAYASHI, K.	Rq U	UJPN	HAYASHI, KA.	Rq U2	UJPN	ARASHIMA	Rq U	UJPN	YAMAMOTO
Rq U3	UJPN	MIYAZAKI	Rq U3	UJPN	FUKUSHIMA	Rq U4	UJPN	YAMAZAWA	Rq U3	UJPN	MASHITA	Rq U4	UJPN	UEDA, M.
Rq U4	UJPN	ISHIBASHI	Rq U4	UJPN	YADA	Rq U5	UJPN	KYOTANI	Rq U4	UJPN	FUKUTOMI	Rq U5	UJPN	SUZUKI, M.
Rq U5	UJPN	HAYASHI, KI.	Rq U5	UJPN	HIROSAKA	Rq U6	UJPN	SUZUKI, M.	Rq U5	UJPN	HIBI	Rq U6	UJPN	IDE
Rq U6	UJPN	ARASHIMA	Rq U6	UJPN	KAMIGASO	Rq U7	UJPN	MIYAZAKI	Rq U6	UJPN	NAKAMURA	Rq U7	UJPN	NAKAJIMA
Rq U7	UJPN	OTSUKA	Rq U7	UJPN	ARAI	Rq U8	UJPN	KOGA	Rq U7	UJPN	MATSUMOTO, E.	Rq U8	UJPN	HAYASHI, KI.
Rq U8	UJPN	TATSUMI	Rq U8	UJPN	OTSUKA	E1 J/M/0	UJPN	TANAKA, M.	Rq U8	UJPN	MITO	E1 J/M/0	UJPN	SHINJO
E1 J/M/0	B1	RDT	E1 J/M/0	B1	KV	E1 J/M/0	B2	DUONG, T	E1 J/M/0	B2	GV	E1 J/M/0	B2	WRT
E1 J/M/0	B2	WRT	E1 J/M/0	B2	LIS	E1 J/M/0	C1	YAMASHITA	E1 J/M/0	B2	KV	E1 J/M/0	C1	RDG
E1 J/M/0	B2	SPK	E1 J/M/0	C1	LIS	E1 J/M/0	C1	FURUKAWA	E1 J/M/0	C1	RDG	E1 J/M/0	C1	LIT
E1 J/M/0	C1	LIS	E1 J/M/0	C1	KV	E1 J/M/0	C1	KASAMATSU	E1 J/M/0	C1	KV	E1 J/M/0	C1	LIT
E1 J/M/0	C1	SPK	E1 J/M/0	B2	THO	E1 J	J	SHIBATA etc.	E1 J/M/0	C1	HIS	E1 J	J	JWRT
E1 J/M/0	C1	CON	E1 J/M/0	C1	CON	E1 J	J	MOTOBAYASHI	E1 J/M/0	C1	HIS	E1 J	J	JWRT
Rq U1	UJPN	KANEDA	Rq U1	UJPN	KONDO	Rq U	UJPN	INUJI	Rq U1	UJPN	KAN	Rq U	UJPN	HIBI
Rq U2	UJPN	SHIMA	Rq U2	UJPN	KOBAYASHI, K.	Rq U	UJPN	HAYASHI, KA.	Rq U2	UJPN	ARASHIMA	Rq U	UJPN	YAMAMOTO
Rq U3	UJPN	MIYAZAKI	Rq U3	UJPN	FUKUSHIMA	Rq U4	UJPN	YAMAZAWA	Rq U3	UJPN	MASHITA	Rq U4	UJPN	UEDA, M.
Rq U4	UJPN	ISHIBASHI	Rq U4	UJPN	YADA	Rq U5	UJPN	KYOTANI	Rq U4	UJPN	FUKUTOMI	Rq U5	UJPN	SUZUKI, M.
Rq U5	UJPN	HAYASHI, KI.	Rq U5	UJPN	HIROSAKA	Rq U6	UJPN	SUZUKI, M.	Rq U5	UJPN	HIBI	Rq U6	UJPN	IDE
Rq U6	UJPN	ARASHIMA	Rq U6	UJPN	KAMIGASO	Rq U7	UJPN	MIYAZAKI	Rq U6	UJPN	NAKAMURA	Rq U7	UJPN	NAKAJIMA
Rq U7	UJPN	OTSUKA	Rq U7	UJPN	ARAI	Rq U8	UJPN	KOGA	Rq U7	UJPN	MATSUMOTO, E.	Rq U8	UJPN	HAYASHI, KI.
Rq U8	UJPN	TATSUMI	Rq U8	UJPN	OTSUKA	E1 J/M/0	UJPN	HATANO	Rq U8	UJPN	MITO	E1 J/M/0	UJPN	HIGUCHI
E1 J/M/0	B1	MGV α1	E1 J/M/0	B1	MGV α1	E1 J/M/0	B2	UEDA, M.	E1 J/M/0	B1	MGV α1	E1 J/M/0	B2	FUJII, M.
E1 J/M/0	B2	KV	E1 J/M/0	B2	KV	E1 J/M/0	C1	IWAI, Y.	E1 J/M/0	B1	MGV α2	E1 J/M/0	C1	FURUTA
E1 J/M/0	C1	WRT	E1 J/M/0	C1	TACHIKAWA	E1 J/M/0	C1	TANAKA, M.	E1 J/M/0	B2	LIS	E1 J/M/0	C1	WRT
E1 J/M/0	C1	GV	E1 J/M/0	C1	KASAMATSU	E1 J/M/0	C1	MIZUNO	E1 J/M/0	B2	WRT	E1 J/M/0	C1	SPK
E1 J/M/0	C1	WRT	E1 J/M/0	C1	YAMASHITA	E1 J/M/0	C1	KOMORI	E1 J/M/0	C1	WRT	E1 J/M/0	C1	SPK
E1 J/M/0	C1	THO	E1 J/M/0	C1	FURUKAWA	E1 J/M/0	B2	KUBOTA	E1 J/M/0	C1	SPK	E1 J/M/0	C1	SPK
E1 J/M/0	B2	LIT	E1 J/M/0	B2	NAKATA	E1 J	J	KUBOTA	E1 J/M/0	C1	SPK	E1 J	J	WRT
E1 J/M/0	B2	JWRT	E1 J/M/0	B2	SANO, M.	E1 J	J	SETO	E1 J/M/0	C1	JWRT	E1 J	J	WRT
E1 J	B2	JWRT	E1 J/M/0	C1	CON	E1 J/M/0	C1	CON	E1 J	B2	JWRT	E1 J	B2	JWRT

I

II

Monday		Tuesday		Wednesday		Thursday		Friday						
E1	J/M/0	A2	GV	TACHIKAWA	IMAI	RqE1	U	GOTO	GOMYO	Rq	U	CHEM	TORLUMI	
E1	J/M/0	B1	SPK	KYOTANI	MATSUURA	RqE1	U	TAKISAWA	TAKAHASHI	Rq	U	CHEM	NAITO	
E1	J/M/0	C1	KV	CHIDA	NAKATANI	RqE1	U	OGAWAYOKO	FUJI	Rq	U	CHEM	NAKAYAMA	
E1	J/M/0	B2	HIS	HISAOKA	SASAGAWA	RqE1	U	SATO, T.	MIGUCHI	Rq	U	CHEM	HARADA	
E1	J/M/0	C1	HIS	SANO, M.	HIBI	RqE1	U	TOGAWA	MIYATA	Rq	U	CHEM	HONMA	
E1	J/M/0	B2	LIT	GONOJI	MATSUMURA	RqE1	U	NEMURA	MORITA	Rq	U	CHEM	MATSUMOTO, A.	
E1	J	B2	JWRT	ISHIBASHI	JC	YAMAKAWA	RqE1	U	HANDA	YAMADA	Rq	U	CHEM	MIKURIYA
E1	J	B2	JWRT	KANEDA	MDR	IWAI, S.	E1	J/M/0	MIYAZAKI	WAMBA	E1	J/M/0	B1	MATSUOKA
E1	J	B2	JWRT	TANAKA, Y.	MDR	KOMORI	E1	J/M/0	WADA	SHANADA	E1	J/M/0	B2	ATARASHI
					MDR	TAKAI	E1	J/M/0	HATANO	MITO	E1	J/M/0	C1	FUJII, M.
					MDR	TACHIKAWA	E1	J/M/0	MAKATA	C10LCA, R.	E1	J/M/0	C1	WATANABE, C.
					MDR	FUJIIHIRA	E1	J/M/0	KOGA	INOMO	E1	J/M/0	C1	SHIBATA
					MDR	MATSUOKA	E1	J/M/0	IWAI, S.	YAMAMOTO, K.	E1	J/M/0	C1	KOYAMA
					Rq	IWAI, Y.	E1	J/M/0	IMURA	MASHITA	E1	J/M/0	B2	SUZUKI, Y.
					Rq	KISHIDA	E1	J	SUZUKI, M.		E1	J	B2	HIGUCHI
					Rq	SANO, M.								
					Rq	SHIBATA								
					Rq	SHOJI								
					Rq	NAKATA								
					Rq	MURATA								
					Rq	GONOJI								
					Rq	MIZUNO								

E1	J/M/0	B2	RDG	KAWASHIMA	IMAI	UJPN	UJPN	GOTO	GOMYO	Rq	U	CHEM	TORLUMI
E1	J/M/0	C1	WRT	BABA	MATSUURA	UJPN	UJPN	TAKISAWA	TAKAHASHI	Rq	U	CHEM	NAITO
E1	J/M/0	C1	SPK	IWADE	NAKATANI	UJPN	UJPN	OGAWAYOKO	FUJI	Rq	U	CHEM	NAKAYAMA
E1	J/M/0	C1	LIN	YAMAKAWA	SASAGAWA	UJPN	UJPN	SATO, T.	MIGUCHI	Rq	U	CHEM	HARADA
E1	J/M/0	C1	EDU	FUJIIHIRA	HIBI	UJPN	UJPN	TOGAWA	MIYATA	Rq	U	CHEM	HONMA
E1	M/0	HIS	FUKUMITSU	FUKUMITSU	MATSUMURA	UJPN	UJPN	NEMURA	MORITA	Rq	U	CHEM	MATSUMOTO, A.
E1	J/M/0	B2	CON	TSUNODA	YAMAKAWA	UJPN	UJPN	HANDA	YAMADA	Rq	U	CHEM	MIKURIYA
					IWAI, S.	JDR	JDR	DIJONG, T	KAI	E1	J/M/0	B2	ATSUTA
					GONOJI	JDR	JDR	KOMORI	UEDA, A.	E1	J/M/0	C1	ONISHI
					KOMORI	JDR	JDR	NAKATA	YAMAMOTO, K.	E1	J/M/0	B2	SHIBATA
					TAKAI	JDR	JDR	HIROKAWA	ATSUTA	E1	M/0	CON	WATANABE, C.
					MIZUNO	JDR	JDR	IWAI, Y.	INOMO	E1	J/M/0	C1	ITO
					MURATA	JDR	JDR	TAKAI	KOBAYASHI, S.	E1	J/M/0	C1	KOYAMA
					FUJIIHIRA	JDR	JDR	WADA	OKUNO	E1	J	B2	ATARASHI
						0	OJPN			E1	J	B2	

E1	U	UJPN	UJPN	SHOJI	VRBOVSKY	ENG	ENG	HIROKAWA	KIM	E1	J/M/0	B1	RDG
E1	U	UJPN	UJPN	MURATA	IWAI, Y.	UJPN	UJPN	SHOJI	ATSUTA	E1	J/M/0	B2	LIS
E1	J/M/0	C1	LIS	IWADE	SHOJI	UJPN	UJPN	VRBOVSKY	OKUNO	E1	J/M/0	C1	RDG
E1	J/M/0	C1	GV	KAWASHIMA	MURATA	UJPN	UJPN	BURENINA	TAKATSUKI	E1	J/M/0	C1	LIS
E1	J/M/0	B2	LIN	IMAI	MIZUNO	MIS	MIS	OTANI	PENG	E1	J/M/0	B2	CON
E1	J/M/0	B2	HIS	FUKUMITSU	IWAI, S.	MIS	MIS			E1	J/M/0	C1	CON
E1	J/M/0	B2	SOC	HAYASHI, H.	GONOJI	JDR	JDR			E1	J	B2	JWRT
					MATSUMURA	JDR	JDR			E1	J	B2	
					YAMAKAWA	JDR	JDR			E1	J	B2	
					IMAI	JDR	JDR			E1	J	B2	
					MATSUURA	JDR	JDR			E1	J	B2	

M

Spring and Summer Terms, 2024

Monday			Tuesday			Wednesday			Thursday			Friday			
level	subject	code	Instructor(s)	level	subject	code	Instructor(s)	level	subject	code	Instructor(s)	level	subject	code	Instructor(s)
B1	RDG	390010	JIN	B1	KV	390040	DUONG, T	B2	SPK	390076	TANAKA, M.	B2	GV	390087	FUJII, C.
B2	WRT	390065	ABE	B2	LIS	390055	YAMASHITA	B2	GV	390086	UEDA, M.	B2	KV	390097	TATSUMI
B2	SPK	390075	MATSUSHIMA	C1	LIS	390114	FURUKAWA	C1	KV	390153	KITAGAWA	C1	RDG	390106	NONAKA
C1	LIS	390110	CHIDA	C1	KV	390151	KASAMATSU	C1	CON	390222	BEREZIKOVA	C1	KV	390155	TANAKA, S.
C1	SPK	390130	TANAKA, Y.	B2	THO	390185	SHIBATA <i>etc.</i>	C1	SOC	390230	KUBOTA	C1	HIS	390197	TAIRA
C1	CON	390220	MOTOHAYASHI												
B1	MGV α 1	390001	TANAKA, Y.	B1	MGV α 1	390001	TAKAI	B1	LIS	390015	HATANO	B1	MGV α 1	390001	FUJII, C.
B1	MGV α 2	390002	KYOTANI	B1	MGV α 2	390002	TACHIKAWA	B2	KV	390096	UEDA, M.	B1	MGV α 2	390002	TATSUMI
B2	KV	390095	ABE	B2	GV	390085	KASAMATSU	C1	LIS	390115	IWAI, Y.	B2	KV	390098	FURUTA
C1	WRT	390121	CHIDA	C1	SPK	390132	YAMASHITA	C1	GV	390143	TANAKA, M.	B2	WRT	390067	NONAKA
C1	GV	390140	MATSUSHIMA	C1	GV	390142	FURUKAWA	C1	LIT	390200	MIZUNO	C1	WRT	390124	TANAKA, S.
C1	THO	390180	MOTOHAYASHI	C1	LIN	390161	NAKATA	B2	EDU	390240	KOMORI	C1	SPK	390133	HATANO
B2	LIT	390205	HISAOKA	C1	HIS	390193	SANO, M.								
				C1	CON	390221	SETO								
A2	GV	390020	TACHIKAWA	MDR	390260	IWAI, S.		B1	SPK	390026	MIYAZAKI	B1	WRT	390021	NAMBA
B1	SPK	390025	KYOTANI	MDR	390261	KOMORI		B2	LIS	390056	WADA	B2	SPK	390077	SANADA
C1	KV	390150	CHIDA	MDR	390262	TAKAI		C1	LIS	390112	HATANO	C1	KV	390156	MITO
B2	HIS	390191	HISAOKA	MDR	390263	TACHIKAWA		C1	GV	390144	NAKATA	C1	LIN	390163	CTOLCA, R.
C1	HIS	390196	SANO, M.	MDR	390264	FUJIHIRA		C1	KV	390154	KOGA	B2	HIS	390194	INOHO
B2	LIT	390206	GONOJI	MDR	390265	MATSUOKA		B2	CON	390227	IWAI, S.	C1	HIS	390198	YAMAMOTO, K.
								C1	SOC	390231	IMURA				
B2	RDG	390045	KAWASHIMA					B1	GV	390030	DUONG, T	B1	KV	390041	KAI
C1	WRT	390122	BARA					B2	WRT	390066	KOMORI	B2	RDG	390047	UEDA, A.
C1	SPK	390131	IWADE					C1	RDG	390105	NAKATA	C1	WRT	390125	YAMAMOTO, K.
C1	LIN	390160	YAMAKAWA					C1	WRT	390123	HIROKAWA	C1	GV	390145	ATSUTA
C1	EDU	390175	FUJIHIRA					B2	LIN	390168	IWAI, Y.	C1	HIS	390199	INOHO
—								C1	EDU	390176	TAKAI	B2	CON	390229	KOBAYASHI, S.
B2	CON	390226	TSUNODA												
C1	LIS	390111	IWADE	MIS	390250	MIZUNO		B2	RDG	390046	HIROKAWA	B1	RDG	390011	KIM
C1	GV	390141	KAWASHIMA	MIS	390251	IWAI, S.		C1	LIN	390162	SHOJI	B2	LIS	390058	ATSUTA
B2	LIN	390167	IMAI					—	LIN	390166	FRBOISKY	C1	RDG	390107	OKUNO
B2	HIS	390192	FUKUMITSU					C1	THO	390181	BURENINA	C1	LIS	390113	TAKATSUKI
B2	SOC	390235	HAYASHI, H.					B2	CON	390228	OTANI	B2	CON	390430	PENG

I

II

III

IV

V

My Weekly Schedule

	Monday	Tuesday	Wednesday	Thursday	Friday
I					
II					
III					
IV					
V					

略号 / Abbreviations

プログラム/Programs	
【U】	Undergraduate Students Program
【J】	Japanese Studies Program
【M】	Maple Program
【F】	OU Foundation Program (秋～冬学期のみ)
【O】	OU-MU Program

日本語レベル/Japanese Levels	
A2	初中級/Pre-intermediate
B1	中級/Intermediate
B2	中上級/Upper-intermediate
C1	上級/Advanced

授業科目/Subjects for 【J】 【M】 【F】 【O】 Program	
日本語実習科目/Japanese Language Subjects	
RDG	読解/Reading
LIS	聴解/Listening
WRT	文章表現/Writing
SPK	口頭表現/Speaking
GV	文法・語彙/Grammar & Vocabulary
KV	漢字・語彙/Kanji & Vocabulary
JWRT	J文章表現/Writing for 【J】 Program Students
MGV	現代日本語初中級文法・語彙/現代日本語中級文法・語彙/Grammar & Vocabulary for 【M】 Program Students
研究科目/Research Subjects	
LIN	日本語学研究基礎/日本語学研究/Japanese Linguistics
EDU	日本語教育学研究基礎/日本語教育学研究/Japanese Language Education
THO	日本思想文化学研究基礎/日本思想文化学研究/Japanese Thought
HIS	日本歴史文化学研究基礎/日本歴史文化学研究/Japanese History
LIT	日本文献文化学研究基礎/日本文献文化学研究/Japanese Literature
CON	日本近現代文化学研究基礎/日本近現代文化学研究/Japanese Contemporary Culture
SOC	日本社会文化学研究基礎/日本社会文化学研究/Japanese Social Sciences
専門演習科目/Seminar Subjects	
JDR	日本語・日本文化研究指導/日本語・日本文化研修指導/Directed Research and Reading for 【J】 Program Students
MDR	日本語日本文化専門演習/Directed Research and Reading for 【M】 Program Students
MIS	自主研究/Independent Studies for 【M】 Program Students

授業科目/Subjects for 【U】 【F】 【O】 Program	
UJPN	学部留学生日本語/Japanese for 【U】 Program Students
FJPN	OU学部留学生日本語/Japanese for 【F】 Program Students (秋～冬学期のみ)
OJPN	大阪・マヒドン留学生日本語/Japanese for 【O】 Program Students
JC	日本事情/Japanese Cultural Background
BIOL	生物/Biology
CHEM	化学/Chemistry
MATH	数学/Mathematics
PHYS	物理/Physics
HIST	日本史/History (秋～冬学期のみ)
POLI	政治・経済/Politics & Economics (秋～冬学期のみ)

みのお
箕面キャンパスマップ
Minoh Campus Map

箕面キャンパスマップ Minoh Campus Map

- ① Graduate School of Language and Culture/School of Foreign Studies
- ② Center for Japanese Language and Culture
- ③ International Studies Library

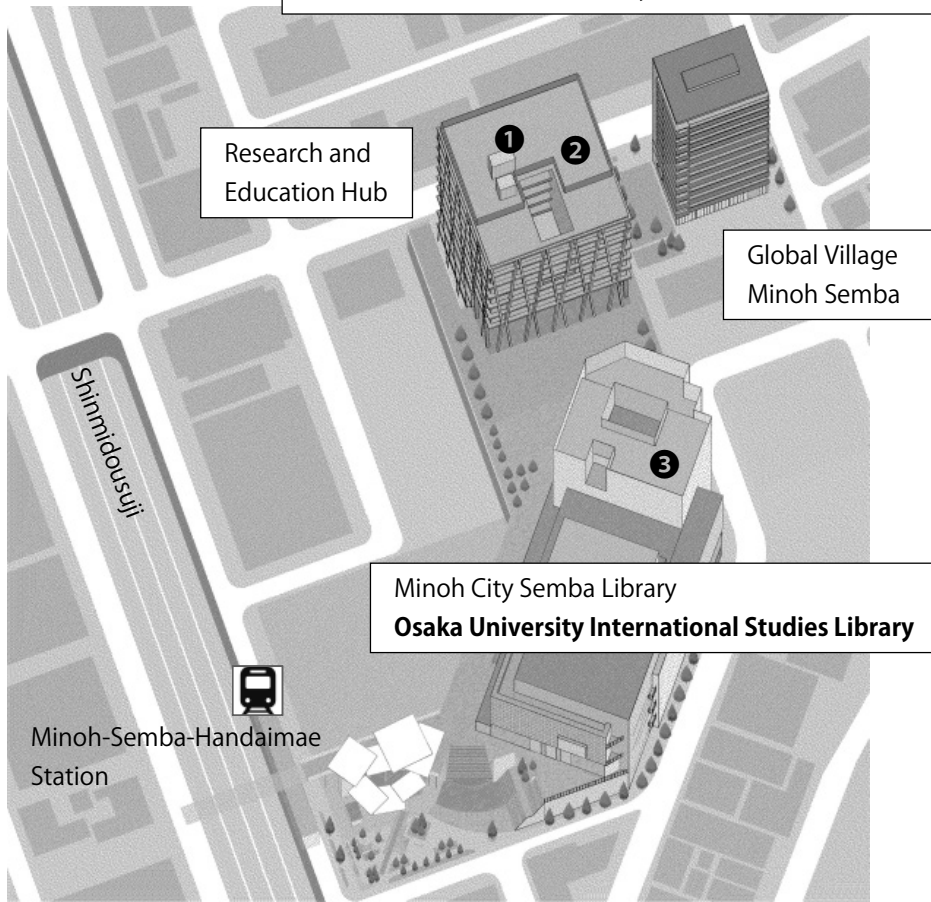

○住所

〒562-8678 大阪府箕面市船場東3丁目5番10号 / 3-5-10, Senba-higashi, Minoh, Osaka

【周辺駅・バス停地図 / Map of the surrounding Area】



○アクセス

- 電車 北大阪急行線 箕面船場阪大前駅下車 徒歩約3分
- バス 阪急バス [千里中央バスターミナルから]
箕面中央線 箕面船場阪大前駅バス停下車 徒歩約3分
小野原東線 (※朝・夕のみ) 船場団地バス停下車 徒歩約1分
豊中市内線 新船場南橋バス停下車 徒歩約7分

○How to get to Minoh Campus

- By railway
Kita Osaka Kyuko Railway, get off at Minoh-Semba-Handai-mae Station
→ 3 minutes on foot
- By Bus
Hankyu Bus [From Senri-Chuo Bus Terminal]
Minoh Chuo Line, get off at Minoh-Semba-Handai-mae Station bus stop
→ 3 minutes on foot
Onohara Higashi Line (*only in the morning and evening), get off at Senba Danchi bus stop
→ 1 minute on foot
Toyonaka City Line, get off at ShinSemba Minami-bashi bus stop
→ 7 minutes on foot

フロア図 (関連部分抜粋)

外国学研究講義棟 Research and Education Hub	
10F	外国語学部
9F	外国語学部
8F	外国語学部
7F	日日センター CJLC (Center for Japanese Language and Culture)
6F	講義室
5F	講義室・交流空間
4F	サイバー・講義
3F	食堂、ロビー、南玄関
2F	事務部門・会議等
1F	北玄関, 記念ホール, 設備等

1F

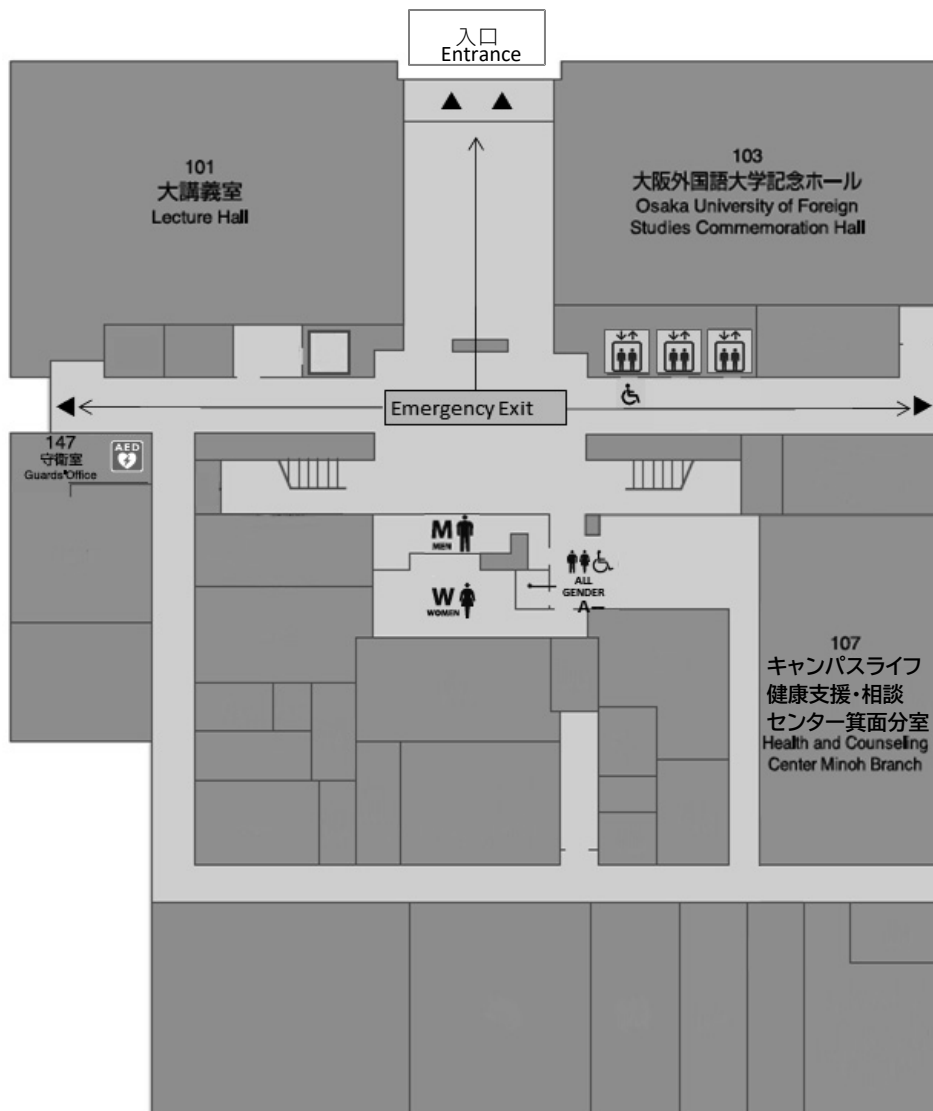

2F

吹き抜け

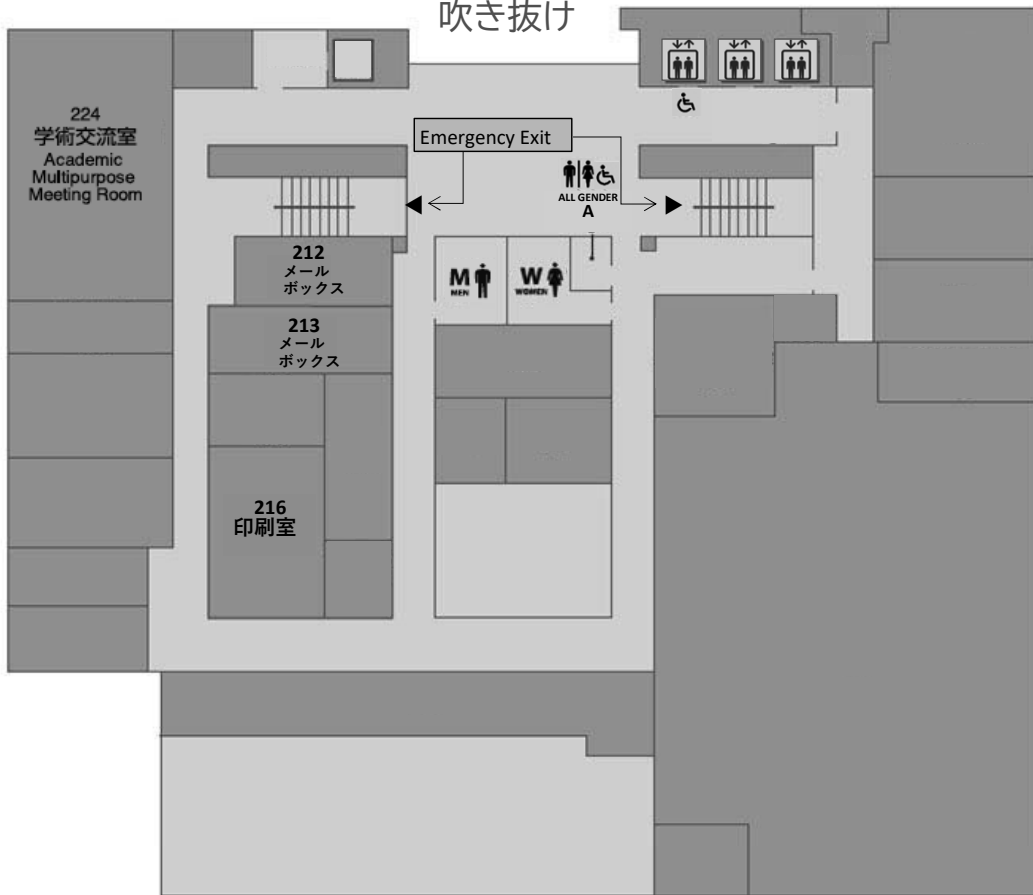

5F

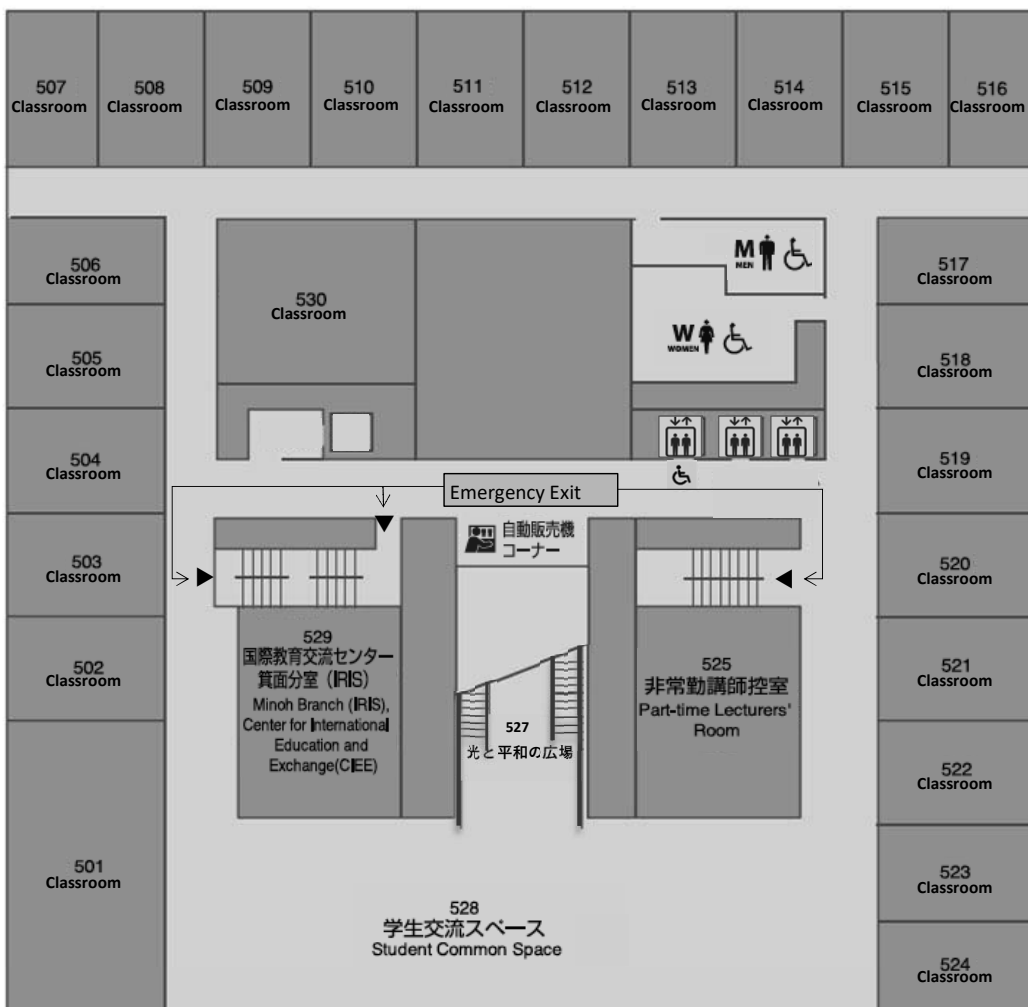

6F

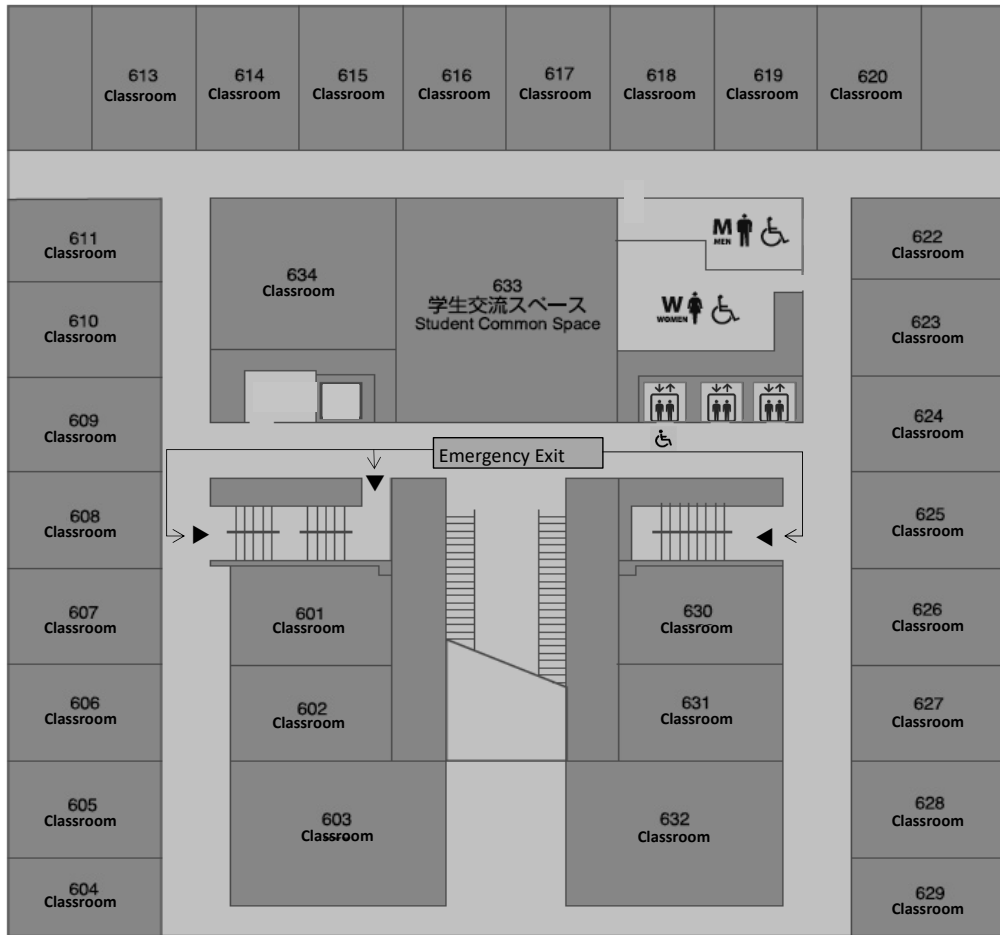

7F

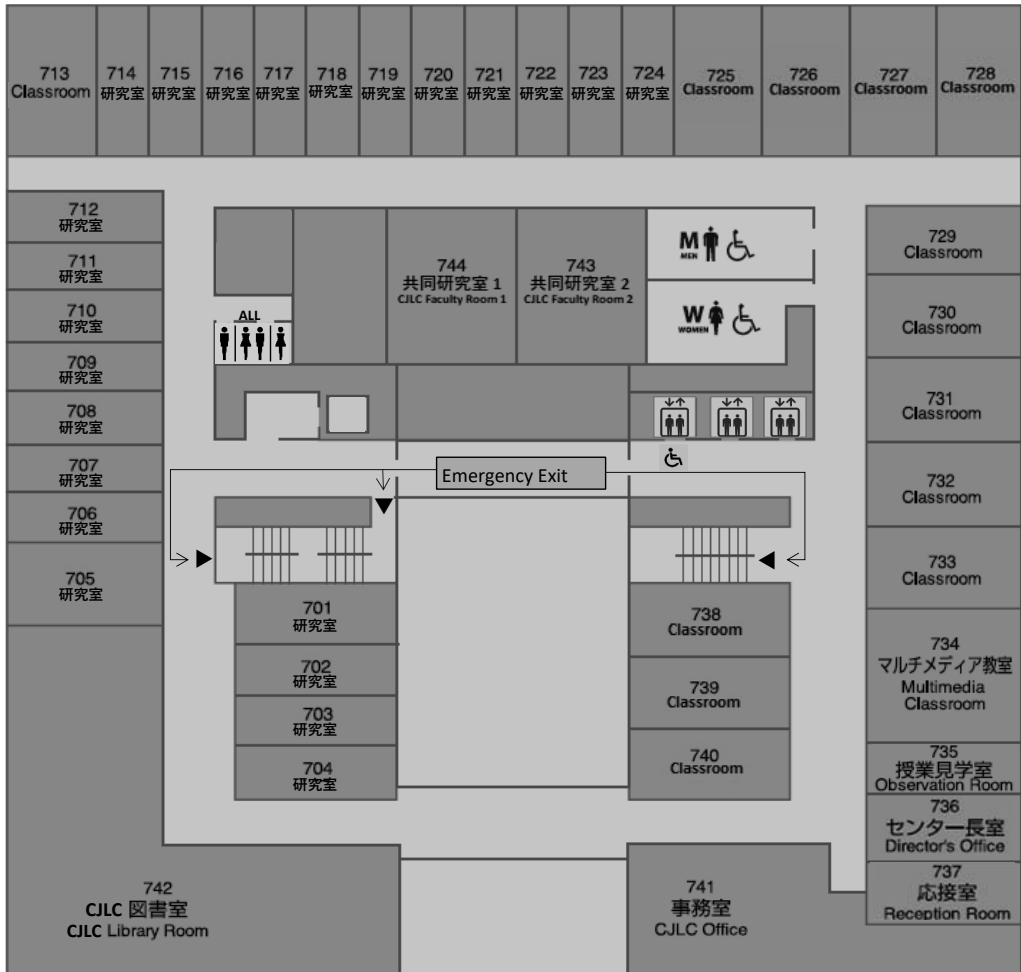

部屋番号 Room Number	施設 Facility
743	共同研究室 1 CJLC Faculty Room 1
744	共同研究室 2 CJLC Faculty Room 2
745	共同研究室 3 CJLC Faculty Room 3

教員研究室

Instructor's Office

部屋番号 Room Number	教員名 Instructor's Name	部屋番号 Room Number	教員名 Instructor's Name
701	日比 伊奈穂 HIBI I.	714	松浦 幸祐 MATSUURA K.
702	松岡 里奈 MATSUOKA R.	715	岩井 康雄 IWAI Y.
703	下村 朱有美 SHIMOMURA A. 笹川 史絵 SASAGAWA F.	716	佐野 方郁 SANO M.
704	藤平 愛美 FUJIHIRA M.	717	高井 美穂 TAKAI M.
706	松村 薫子 MATSUMURA K.	718	岸田 泰浩 KISHIDA Y.
707	中谷 真也 NAKATANI S.	719	荘司 育子 SHOJI I.
708	岩井 茂樹 IWAI S.	720	小森 万里 KOMORI M.
709	中田 一志 NAKATA H.	721	水野 亜紀子 MIZUNO A.
710	柴田 芳成 SHIBATA Y.	722	立川 真紀絵 TACHIKAWA M.
711	今井 忍 IMAI S.	723	五之治 昌比呂 GONOJI M.
712	山川 太 YAMAKAWA F.	724	村田 真実 MURATA M.

アドバイザー / Advisors

[U] Program		[J] Program	
U1 }	YAMAKAWA F. IMAI S. MATSUMURA K.	SHIBATA Y. IWAI Y. KISHIDA Y. NAKATA H. IMAI S. SHOJI I. GONOJI M. IWAI S. KOMORI M. YAMAKAWA F. MATSUMURA K. SANO M. MIZUNO A. TAKAI M. MURATA M. TACHIKAWA M. MATSUURA K.	NAKATA H. IMAI S. SHOJI I. GONOJI M. IWAI S. KOMORI M. YAMAKAWA F. MATSUMURA K. SANO M. MIZUNO A. TAKAI M. MURATA M. TACHIKAWA M. MATSUURA K.
U8	MATSUURA K. HIBI I. NAKATANI S. SASAGAWA F.		
[M] Program			
M1 }	TAKAI M. IWAI S. KOMORI M.		
M6	TACHIKAWA M. FUJIHIRA M. MATSUOKA R.		

発 行 令和6年3月

Published in March, 2024

編 集 大阪大学日本語日本文化教育センター

Edited by Center for Japanese Language and Culture,
Osaka University

〒562-8678 大阪府箕面市船場東3丁目5番10号
3-5-10, Senba-higashi, Minoh, Osaka

Phone (072) 730-5075, 5072

(日本語日本文化教育センター事務室)

<http://www.cjlc.osaka-u.ac.jp/>

Email cjlc@office.osaka-u.ac.jp